



# Government Gazette Staatskoerant

REPUBLIC OF SOUTH AFRICA  
REPUBLIEK VAN SUID-AFRIKA

Vol. 442

Pretoria, 26 April 2002

**No. 23370**



23370

9771682584003



**AIDS HELPLINE: 0800-0123-22 Prevention is the cure**

---

**CONTENTS • INHOUD***No.**Page  
No.      Gazette  
No.***GENERAL NOTICE****Trade and Industry, Department of***General Notice*

- 645 Manufacturing Development Act (187/1993): Designation of an area as an Industrial Development Zone (IDZ):  
East London IDZ.....

3 23370

---

---

## GENERAL NOTICE

---

### NOTICE 645 OF 2002

#### DEPARTMENT OF TRADE AND INDUSTRY

#### MANUFACTURING DEVELOPMENT ACT No. 187 of 1993

I, Alexander Erwin, Minister of Trade and Industry, by virtue of the power vested in me in terms of Chapter II, Regulation 3 Gazette No.6936 Vol.426 dated 1 December 2000 ("the Regulations"), of the Manufacturing Development Act (Act No. 187 of 1993 as amended), promulgated a notice in respect of the Industrial Development Zone Programme.

#### DESIGNATION OF AN AREA AS AN INDUSTRIAL DEVELOPMENT ZONE (IDZ)

##### 1. DESIGNATION OF AN AREA AS AN IDZ: EAST LONDON IDZ

In terms of Chapter II, Regulation 3 (a) of the Regulations, it is hereby proclaimed that an area, which is called the East London Industrial Development Zone, is designated as an IDZ.

The aforesaid designation is made in accordance and after due compliance with the prescribed requirements as provided for in Chapter II, Regulation 3 (a) (1) to (6) and (b) (1) to (3) of the Regulations.

##### 2. THE LOCATION OF THE EAST LONDON INDUSTRIAL DEVELOPMENT ZONE

A land area of approximately 1500 hectares of land on the West Bank of the City of East London has been identified as suitable for industrial development by the planning authorities of the City of East London. Within this area is the initial 375 hectares site for the first phase of the East London IDZ. The site is 4km west of the Buffalo River and Harbour, and approximately 2km south of the East London Airport. It is bordered on the south by the Indian Ocean. Phase 1a and 1b lie between river systems, the Mvubukazi River on the east and the Ngqenga River on the western boundary.

The East London IDZ falls within the Buffalo City municipal area. The plan showing the boundaries of the proposed IDZ is attached as Annexure A and a list of properties that will be affected by the demarcation is attached as Annexure B. Annexure C shows the actual position or location of each property within the proposed IDZ.

### **3. APPLICATIONS FOR PROVISIONAL OPERATOR PERMITS**

Any party interested in obtaining a Provisional IDZ Operator Permit (PIDZOP) is invited to submit a Provisional East London IDZ Operator Permit application to the Manufacturing Development Board. Application must comply with Chapter IV, Regulation 10 (d) and (e) of the Regulations. All applications for the Provisional East London IDZ Operator Permit must be addressed to:

Ms Brenda Mabaso-Simelane  
Department of Trade and Industry  
Private Bag X86

Fax: (012) 322 0011

Tel: (012) 310 1230

E-mail: [brendas@dti.pwv.gov.za](mailto:brendas@dti.pwv.gov.za)

**ALEC ERWIN, MP**  
**MINISTER: TRADE AND INDUSTRY**

## Annex. A

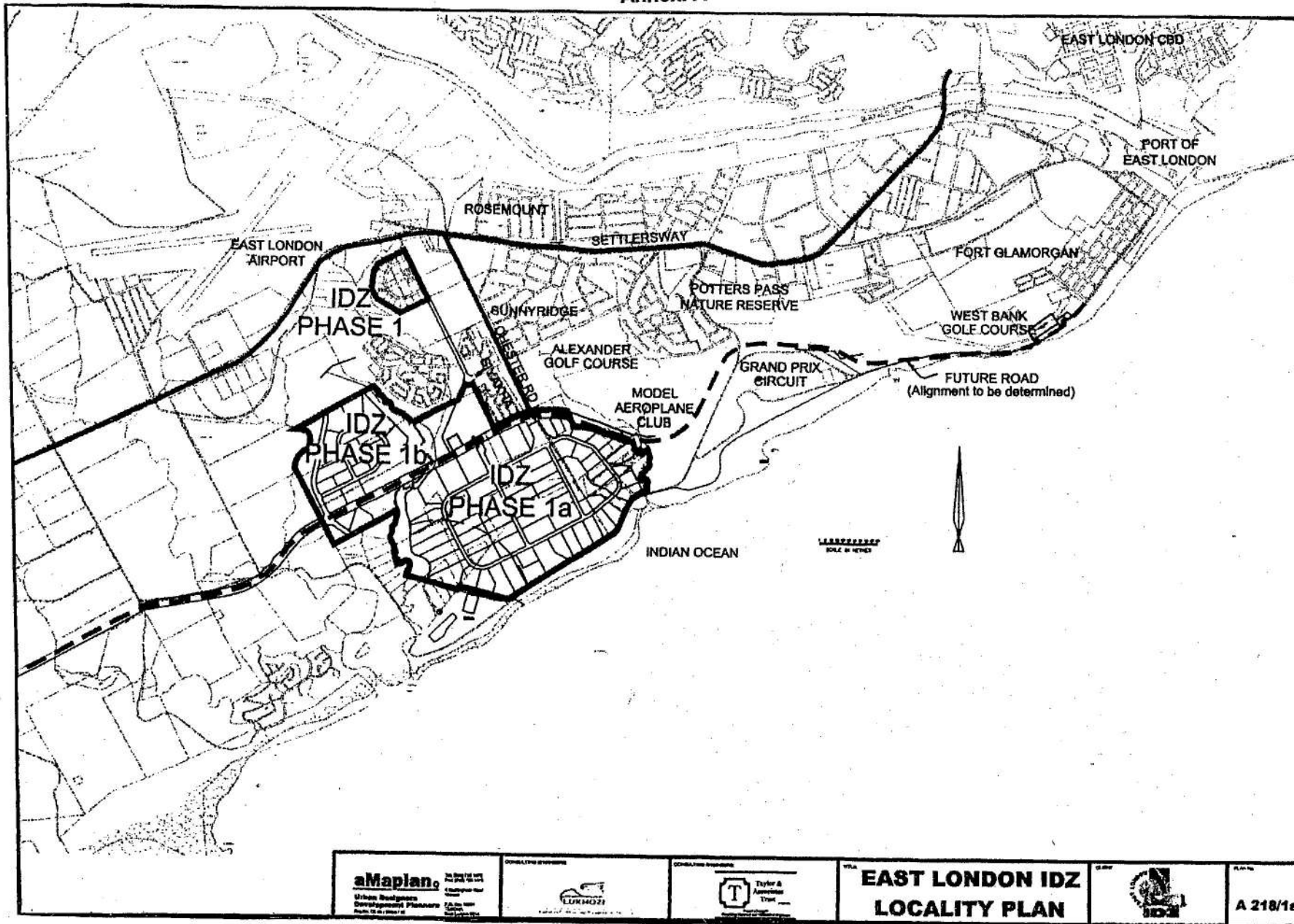

**Annex. B.****East London IDZ: Schedule of Properties**

No:	Property Description	Owner
1.	Portion of Farm 1344	Buffalo City Municipality
2.	Portion of Farm 1216/2	Buffalo City Municipality
3.	Farm 1216/3	Buffalo City Municipality
4.	Farm 951	Buffalo City Municipality
5.	Farm 951/2	Buffalo City Municipality
6.	Farm 951/1	Buffalo City Municipality
7.	Farm 1242/4	Buffalo City Municipality
8.	Portion of Farm 1242	Buffalo City Municipality
9.	Portion of Farm 952/15	Buffalo City Municipality
10.	Portion of Farm 952/24	Buffalo City Municipality
11.	Farm 952/20	Buffalo City Municipality
12.	Portion of Farm 1242/1	Buffalo City Municipality
13.	Farm 1242/2	Buffalo City Municipality
14.	Farm 1242/3	Buffalo City Municipality
15.	Portion of Farm 949/6	Buffalo City Municipality
16.	Portion of Farm 949/7	Buffalo City Municipality
17.	Farm 954	Buffalo City Municipality
18.	Portion of Farm 949/1	Buffalo City Municipality
19.	Portion of Farm 949/3	Buffalo City Municipality
20.	Portion of Farm 949/4	Buffalo City Municipality
21.	Portion of Erf 19606	Buffalo City Municipality
22.	Portion of Erf 19607	Buffalo City Municipality
23.	Portion of Chester Road	Buffalo City Municipality

Combined Extent: ± 364 hectares



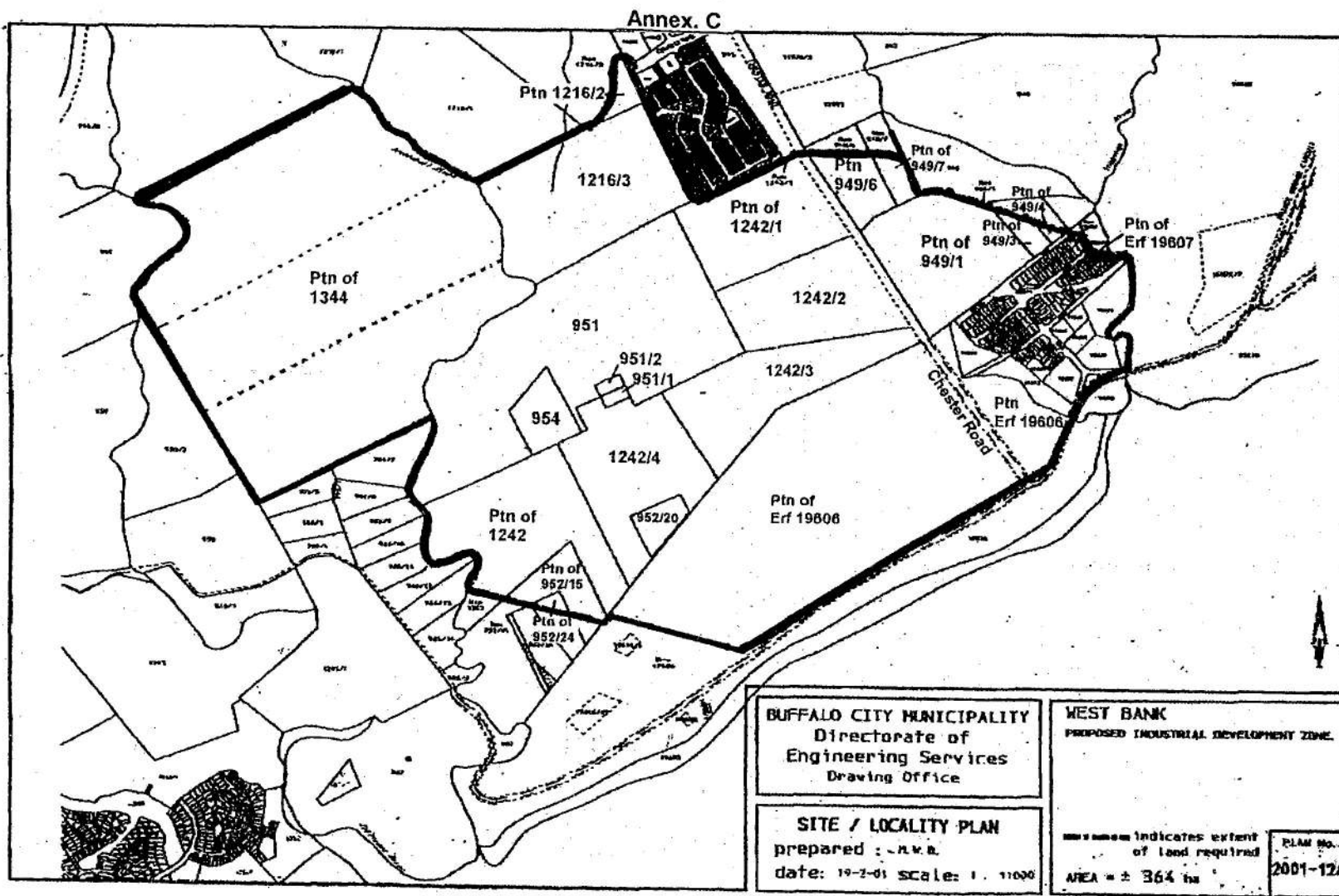

Printed by and obtainable from the Government Printer, Bosman Street, Private Bag X85, Pretoria, 0001  
Publications: Tel: (012) 334-4508, 334-4509, 334-4510  
Advertisements: Tel: (012) 334-4673, 334-4674, 334-4504  
Subscriptions: Tel: (012) 334-4735, 334-4736, 334-4737  
Cape Town Branch: Tel: (021) 465-7531

Gedruk deur en verkrygbaar by die Staatsdrukker, Bosmanstraat, Privaatsak X85, Pretoria, 0001  
Publikasies: Tel: (012) 334-4508, 334-4509, 334-4510  
Advertensies: Tel: (012) 334-4673, 334-4674, 334-4504  
Subskripsies: Tel: (012) 334-4735, 334-4736, 334-4737  
Kaapstad-tak: Tel: (021) 465-7531