

WEDDIE W. M. M. J. 1996
10 FRICKER ROAD
ILLOVO BOULEVARD
JOHANNESBURG 2196



Government Gazette Staatskoerant

REPUBLIC OF SOUTH AFRICA
REPUBLIEK VAN SUID-AFRIKA

Vol. 482

Pretoria, 24 August
Augustus 2005

No. 27959



AIDS HELPLINE: 0800-0123-22 Prevention is the cure

CONTENTS • INHOUD

<i>No.</i>	<i>Page No.</i>	<i>Gazette No.</i>
PROCLAMATIONS		
42 Remuneration of Public Office Bearers Act (20/1998): Salaries and allowances of the Deputy President, Ministers and Deputy Ministers (National Executive Authority).....	3	27959
43 do.: Salaries and allowances of Members of the National Assembly and permanent delegates to the National Council of Provinces (collectively referred as a 'Member of Parliament')	8	27959
44 do.: Upper limits of the salaries and allowances of Premiers, Members of Executive Councils and Members of Provincial Legislatures	14	27959
45 Judges' Remuneration and Conditions of Employment Act (47/2001): Remuneration of Constitutional Court Judges and Judges	20	27959
46 Magistrates Act (90/1993): Salaries, allowances and benefits of magistrates	22	27959

PROCLAMATIONS*by the**President of the Republic of South Africa***No. 42, 2005****SALARIES AND ALLOWANCES OF THE DEPUTY PRESIDENT, MINISTERS AND DEPUTY MINISTERS (NATIONAL EXECUTIVE AUTHORITY)**

- 1 In terms of section 4(1) of the Remuneration of Public Office Bearers Act, 1998 (Act No 20 of 1998) (hereafter referred to as "the Act"), I hereby determine that the annual salaries and allowances of the various grades of office bearers in Column 1 of Schedule 1 and Schedule 2 shall be as set out in Columns 2, 3 and 4 of Schedule 1 with effect from 1 April 2005 subject to sections 4(2)-(7) of the Act.
- 2 Column 4 of Schedule 1 (Notch 3) applies to a re-elected member who has occupied his or her current office, or an office in the same or a higher grade according to Column 1 of Schedule 2, for a period of at least 24 months in total, whether before or after 14 April 2004.
- 3 Column 3 of Schedule 1 (Notch 2) applies to all re-elected members other than those referred to in paragraph (2). When a re-elected member to whom Column 3 applies has held his or her current office, or an office in the same or a higher grade

according to Column 1, for a period of 24 months in total, Column 4 becomes applicable to that member.

- 4 Column 2 of Schedule 1 applies to all members of the National Executive Authority who are not re-elected members.
- 5 For the purpose of calculating the period of 24 months referred to in paragraphs (2) and (3), a re-elected member who-

- (ii) was a Minister, Deputy Minister or a member of Parliament or of a Provincial Legislature on 13 April 2004, and

- (iii) pursuant to the election of 14 April 2004 was, in the case of a Minister or Deputy Minister, appointed by the President as a Minister or Deputy Minister in terms of section 91(3)(c) or section 93(b), respectively, of the Constitution of the Republic of South Africa, 1996 (Act No.108 of 1996) , or in the case of a member of the National Assembly or a Provincial Legislature, was designated by the Electoral Commission as a member of the National Assembly or of a Provincial Legislature, or, in the Case of a Permanent Delegate to the National Council of Provinces, was designated by the Electoral Commission as such in terms of section 61(2)(b) of the Constitution,

is regarded to have continued to occupy the position occupied by him or her on 13 April 2004 until so designated or appointed.

6. In this Proclamation-

- (i) "Member of Parliament" means a member of the National Assembly or a permanent delegate to the National Council of Provinces,
 - (ii) "Re-elected member" means a person –

- (a) who at any time before 14 April 2004 occupied an office in Column 2 of Schedule 2 and
 - (b) whose service in any one or more of those offices has not been interrupted in any time for a continuous period of more than 24 months.
- (iii) The appointment of a person by the President as a Minister or Deputy Minister from outside the National Assembly shall be deemed to be the election of such a person for purposes of this Proclamation.
7. In terms of section 4(3) of the Remuneration of Public Office Bearers Act, I further determine the amount of R40 000, 00 per annum as that portion of the remuneration of the Deputy President, Ministers and Deputy Ministers to which section 8(1)(d) of the Income Tax Act, 1962 (Act No 58 of 1962), applies
8. Proclamation No.56 of 2004, published in the Government Gazette No. 26968 of 5 November 2004, is repealed.

Given under my Hand at Pretoria on this Twenty-second day of August, Two Thousand and Five.



PRESIDENT

SCHEDULE 1										
GRADING STRUCTURE, REMUNERATION AND ALLOWANCES FOR THE DEPUTY PRESIDENT, MINISTERS, DEPUTY MINISTERS (NATIONAL EXECUTIVE AUTHORITY) WITH EFFECT FROM 1-Apr-05										
COLUMN 1		COLUMN 2 (NOTCH 1)			COLUMN 3 (NOTCH 2)			COLUMN 4 (NOTCH 3)		
Grade	Office	Basic salary	Motor vehicle allowance	Total remuneration	Basic salary	Motor vehicle allowance	Total remuneration	Basic salary	Motor vehicle allowance	Total remuneration
Grade G	Deputy President	736 410	184 102	920 512						
Grade F	Minister	608 595	152 149	760 744	639 036	159 759	798 795	669 462	167 365	836 827
Grade E1	Deputy Minister	494 661	123 665	618 326	519 399	129 849	649 248	544 123	136 030	680 153

SCHEDULE 2

Grade	Office
Grade F	<ul style="list-style-type: none"> ▪ Minister (National Executive Authority) ▪ Premier of a Province ▪ Speaker: National Assembly ▪ Chairperson: National Council of Provinces (NCOP)
Grade E1	<ul style="list-style-type: none"> ▪ Deputy Minister (National Executive Authority) ▪ Deputy Speaker: National Assembly ▪ Deputy Chairperson: NCOP ▪ Member of the Executive Council of a Province ▪ Speaker: Provincial Legislature
Grade E2	<ul style="list-style-type: none"> ▪ Parliamentary Counsellor: President ▪ Chief Whip: Majority Party in National Assembly ▪ Chief Whip of NCOP ▪ Leader of the Opposition in terms of section 57(2)(d) of the Constitution.
Grade D	<ul style="list-style-type: none"> ▪ Parliamentary Counsellor: Deputy President ▪ Deputy Speaker: Provincial Legislature
Grade C1	<ul style="list-style-type: none"> ▪ Chairperson of a Committee of a House of Parliament or a Joint Committee ▪ Chairperson of a Committee of a House of Parliament ▪ Chief Whip of Majority party: Provincial Legislature
Grade C2	<ul style="list-style-type: none"> ▪ Chief Whip: Official Opposition/Largest Minority Party in a House of Parliament ▪ Deputy Chief Whip: Majority Party in a House of Parliament ▪ Deputy Chairperson of Committees of a House of Parliament ▪ Leader of Opposition in terms of section 116(2)(d) of the Constitution: Provincial Legislature ▪ Chairperson of a Committee of a Provincial Legislature ▪ Chairperson of Committees: Provincial Legislature
Grade B	<ul style="list-style-type: none"> ▪ Leader of a House of Parliament ▪ Whip in a House of Parliament ▪ Leader of a Minority Party other than the Official Opposition where that Leader is a member of the National Assembly or a permanent delegate to the NCOP ▪ Chief Whip of Official Opposition/Largest Minority Party: Provincial Legislature ▪ Deputy Chief Whip of Minority Party: Provincial Legislature ▪ Deputy Chairperson of Committees: Provincial Legislature
Grade A1	<ul style="list-style-type: none"> ▪ Member of the National Assembly ▪ Permanent Delegate to the NCOP ▪ Leader of Provincial Legislature ▪ Whip: Provincial Legislature ▪ Leader of a Minority Party in a Provincial Legislature other than the Official Opposition
Grade A2	<ul style="list-style-type: none"> ▪ Member of a Provincial Legislature

No. 43, 2005**SALARIES AND ALLOWANCES OF MEMBERS OF THE NATIONAL ASSEMBLY AND
PERMANENT DELEGATES TO THE NATIONAL COUNCIL OF PROVINCES
(COLLECTIVELY REFERRED TO AS 'MEMBERS OF PARLIAMENT')**

- 1 In terms of section 3(1) of the Remuneration of Public Office Bearers Act, 1998 (Act No 20 of 1998) (hereafter referred to as "the Act"), I hereby determine that the annual salaries and allowances of the various grades of office bearers in Column 1 of Schedule 1 and Schedule 2 shall be as set out in Columns 2, 3 and 4 of Schedule 1 with effect from 1 April 2005 subject to section 4(2)-(7) of the Act.
- 2 Column 4 of Schedule 1 (Notch 3) applies to a re-elected member who has occupied his or her current office, or an office in the same or a higher grade according to Column 1 of Schedule 2, for a period of at least 24 months in total, whether before or after 14 April 2004.
- 3 Column 3 of Schedule 1 (Notch 2) applies to all re-elected members other than those referred to in paragraph (2). When a re-elected member to whom Column 3 applies has held his or her current office, or an office in the same or a higher grade

according to Column 1, for a period of 24 months in total, Column 4 becomes applicable to that member.

4 Column 2 of Schedule 1 applies to all members of Parliament who are not re-elected members.

5 For the purpose of calculating the period of 24 months referred to in paragraphs (2) and (3), a re-elected member who-

(ii) was a Minister, Deputy Minister or a member of Parliament or of a Provincial Legislature on 13 April 2004, and

(iii) pursuant to the election of 14 April 2004 was, in the case of a Minister or Deputy Minister, appointed by the President as a Minister or Deputy Minister in terms of section 91(3)(c) or section 93(b), respectively, of the Constitution of the Republic of South Africa, 1996 (Act No.108 of 1996) , or in the case of a member of the National Assembly or a Provincial Legislature, was designated by the Electoral Commission as a member of the National Assembly or of a Provincial Legislature, or, in the case of a permanent delegate to the National Council of Provinces, was designated by the Electoral Commission as such in terms of section 61(2)(b) of the Constitution,

is regarded to have continued to occupy the position occupied by him or her on 13 April 2004 until so designated or appointed.

6. In this Proclamation-

(i) "Member of Parliament" means a member of the National Assembly or a permanent delegate to the National Council of Provinces,

- (a) who at any time before 14 April 2004 occupied an office in Column 2 of Schedule 2 and
 - (b) whose service in any one or more of those offices has not been interrupted in any time for a continuous period of more than 24 months.
- (iii) The appointment of a person by the President as a Minister or Deputy Minister from outside the National Assembly shall be deemed to be the election of such a person for purposes of this Proclamation.
7. In terms of section 4(3) of the Remuneration of Public Office Bearers Act, I further determine the amount of R40 000, 00 per annum as that portion of the remuneration of the members of Parliament to which section 8(1)(d) of the Income Tax Act, 1962 (Act No 58 of 1962), applies.
8. Proclamation No.55 of 2004, published in the Government Gazette No. 26968 of 5 November 2004, is hereby repealed.

Given under my Hand at Pretoria on this Twenty-second day of August, Two Thousand and Five.

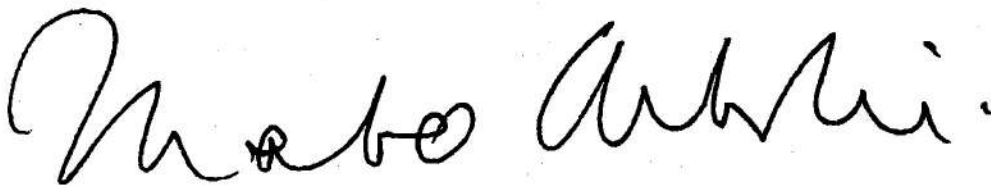

PRESIDENT

SCHEDULE 1**GRADING STRUCTURE, REMUNERATION AND ALLOWANCES OF MEMBERS OF THE NATIONAL ASSEMBLY
AND PERMANENT DELEGATES TO THE NATIONAL COUNCIL OF PROVINCES WITH EFFECT FROM 01 APRIL
2005**

COLUMN 1		COLUMN 2 (NOTCH 1)			COLUMN 3 (NOTCH 2)			COLUMN 4 (NOTCH 3)		
Grade	Office	Basic salary	Motor vehicle allowance	Total remuneration	Basic salary	Motor vehicle allowance	Total remuneration	Basic salary	Motor vehicle allowance	Total remuneration
Grade F	Speaker: National Assembly (NA) Chairperson NCOP	608 595	152 149	760 744	639 036	159 759	798 795	669 462	167 365	836 827
Grade E1	Deputy Speaker: NA Deputy Chairperson: NCOP	494 661	123 665	618 326	519 399	129 849	649 248	544 123	136 030	680 153
Grade E2	Parliamentary Councilor (PC): President Chief Whip Majority Party in NA Chief Whip (CW): NCOP Leader of the Opposition i.t.o section 57(2)(d) of the Constitution	407 497	101 874	509 371	427 875	106 969	534 844	448 267	112 067	560 334
Grade D	PC: Deputy President House Chairperson: NA	387 171	96 792	483 963	414 276	103 569	517 845	425 884	106 471	532 355
Grade C1	Chairperson of a Committee of a House or a Joint Committee Chairperson of Committees	375 173	93 792	468 965	401 430	100 357	501 787	412 675	103 168	515 843
Grade C2	CW: Official Opposition/Largest Minority Party in a House Deputy Chief Whip: Majority Party in a House Deputy Chairperson of Committees	363 591	90 897	454 488	389 041	97 260	486 301	399 950	99 987	499 937
Grade B	Leader of a House Whip in a House Leader of a Minority Party other than the official opposition where that leader is a member of the NA or a permanent delegate to the NCOP	348 969	87 242	436 211	366 416	91 603	458 019	383 862	95 966	479 828

Grade A1	Member of NA Permanent Delegates	310 404	77601	388 005	332 141	83 035	415 176	341 449	85 362	426 811
----------	-------------------------------------	---------	-------	---------	---------	--------	---------	---------	--------	---------

All amounts reflected under the "Total remuneration" columns include an amount of R40 000 per annum determined in this Proclamation as the amount to which section 8(1)(d) of the Income Tax Act, 1962, applies.

SCHEDULE 2	
GRADE	OFFICE
Grade F	Minister (National Executive Authority) Premier of a Province Speaker: National Assembly Chairperson: National Council of Provinces (NCOP)
Grade E1	Deputy Minister (National Executive Authority) Deputy Speaker: National Assembly Deputy Chairperson: NCOP Member of the Executive Council of a Province Speaker: Provincial Legislature
Grade E2	Parliamentary Counsellor: President Chief Whip: Majority Party in National Assembly Chief Whip of NCOP Leader of the Opposition in terms of section 57(2)(d) of the Constitution.
Grade D	Parliamentary Counsellor: Deputy President Deputy Speaker: Provincial Legislature
Grade C1	Chairperson of a Committee of a House of Parliament or a Joint Committee Chairperson of a Committees of a House of Parliament Chief Whip of Majority party: Provincial Legislature
Grade C2	Chief Whip: Official Opposition/Largest Minority Party in a House of Parliament Deputy Chief Whip: Majority Party in a House of Parliament Deputy Chairperson of Committees of a House of Parliament Leader of Opposition in terms of section 116(2)(d) of the Constitution: Provincial Legislature Chairperson of a Committee of a Provincial Legislature Chairperson of Committees: Provincial Legislature
Grade B	Leader of a House of Parliament Whip in a House of Parliament Leader of a Minority Party other than the Official Opposition where that Leader is a member of the National Assembly or a permanent delegate to the NCOP Chief Whip of Official Opposition/Largest Minority Party: Provincial Legislature Deputy Chief Whip of Majority Party: Provincial Legislature. Deputy Chairperson of Committees: Provincial Legislature
Grade A1	Member of the National Assembly Permanent Delegate to the NCOP Leader of Provincial Legislature Whip: Provincial Legislature Leader of a Minority Party in a Provincial Legislature other than the Official Opposition
Grade A2	Member of a Provincial Legislature

No. 44, 2005**UPPER LIMITS OF THE SALARIES AND ALLOWANCES OF PREMIERS, MEMBERS OF THE EXECUTIVE COUNCILS AND MEMBERS OF PROVINCIAL LEGISLATURES**

- 1 In terms of section 6(1) of the Remuneration of Public Office Bearers Act, 1998 (Act No 20 of 1998) (hereafter referred to as "the Act"), I hereby determine that the annual salaries and allowances of the various grades of office bearers in Column 1 of Schedule 1 shall be as set out in Columns 2, 3 and 4 of Schedule 1 with effect from 1 April 2005 subject to section 4(2)-(7) of the Act.
- 2 Column 4 of Schedule 1 (Notch 3) applies to a re-elected member who has occupied his or her current office, or an office in the same or a higher grade according to Column 1 of Schedule 2, for a period of at least 24 months in total, whether before or after 14 April 2004.
- 3 Column 3 of Schedule 1 (Notch 2) applies to all re-elected members other than those referred to in paragraph (2). When a re-elected member to whom Column 3 applies has held his or her current office, or an office in the same or a higher grade according to Column 1, for a period of 24 months in total, Column 4 becomes applicable to that member.
- 4 Column 2 of Schedule 1 applies to all members of the Premiers, Members of Executive Councils and Members of the Provincial Legislatures who are not re-elected members.
- 5 For the purpose of calculating the period of 24 months referred to in paragraphs (2) and (3), a re-elected member who-
 - (ii) was a Minister, Deputy Minister or a member of Parliament or of a Provincial Legislature on 13 April 2004, and

- (iii) pursuant to the election of 14 April 2004 was, in the case of a Minister or Deputy Minister, appointed by the President as a Minister or Deputy Minister in terms of section 91(3)(c) or section 93(b), respectively, of the Constitution of the Republic of South Africa, 1996 (Act No.108 of 1996) , or in the case of a member of the National Assembly or a Provincial Legislature, was designated by the Electoral Commission as a member of the National Assembly or of a Provincial Legislature, or, in the Case of a Permanent Delegate to the National Council of Provinces, was designated by the Electoral Commission as such in terms of section 61(2)(b) of the Constitution,

is regarded to have continued to occupy the position occupied by him or her on 13 April 2004 until so designated or appointed.

6. In this Proclamation-

- (i) "Member of Parliament" means a member of the National Assembly or a permanent delegate to the National Council of Provinces,
 - (a) who at any time before 14 April 2004 occupied an office in Column 2 of Schedule 2 and
 - (b) whose service in any one or more of those offices has not been interrupted in any time for a continuous period of more than 24 months.
- (iii) The appointment of a person by the President as a Minister or Deputy Minister from outside the National Assembly shall deemed to be the election of such a person for purposes of this Proclamation.

7. In terms of section 4(3) of the Remuneration of Public Office Bearers Act, I further determine the amount of R40 000, 00 per annum as that portion of the remuneration of the Deputy President, Ministers and Deputy Ministers to which section 8(1)(d) of the Income Tax Act, 1962 (Act No 58 of 1962) , applies

8. Proclamation No.54 of 2004, published in the Government Gazette No. 26968 of 5 November 2004, is hereby repealed.

Given under my Hand at Pretoria on this Twenty-second day of August, Two Thousand and Five.



PRESIDENT

SCHEDULE 1

UPPER LIMIT OF THE SALARIES AND ALLOWANCES OF PREMIERS, MEMBERS OF EXECUTIVE COUNCILS AND MEMBERS OF PROVINCIAL LEGISLATURES WITH EFFECT FROM 01 APRIL 2005

COLUMN 1		COLUMN 2 (NOTCH 1)			COLUMN 3 (NOTCH 2)			COLUMN 4 (NOTCH 3)		
Grade	Office	Basic salary	Motor vehicle allowance	Total remuneration	Basic salary	Motor vehicle allowance	Total remuneration	Basic salary	Motor vehicle allowance	Total remuneration
Grade F	Premier	608 595	152 149	760 744	639 036	159 759	798 795	669 462	167 365	836 827
Grade E1	Executive Council member Speaker	494 661	123 665	618 326	519 399	129 849	649 248	544 123	136 030	680 153
Grade D	Deputy Speaker	387 171	96 792	483 963	414 276	103 569	517 845	425 884	106 471	532 355
Grade C1	Chief Whip: Majority Party	375 173	93 792	468 965	401 430	100 357	501 787	412 675	103 168	515 843
Grade C2	Leader of Opposition i.t.o section 116(2)(d) of the Constitution Chairperson of a Committee of a Legislature Chairperson of Committees	363 591	90 897	454 488	389 041	97 260	486 301	399 950	99 987	499 937
Grade B	Chief Whip: Official Opposition Largest Minority Party Deputy Chief Whip: Majority Party Deputy Chief Whip: Majority Party Deputy Chairperson of Committees	348 969	87 242	436 211	366 416	91 603	458 019	383 862	95 966	479 828
Grade A1	Parliamentary Counsellor to the King Leader of a Minority Party in a Legislature other than the Official Opposition	310 404	77 601	388 005	332 141	83 035	415 176	341 449	85 362	426 811

Grade A2	Member of a Legislature	298 943	74 735	373 678	307 916	76 978	384 894	328 846	82 211	411 057
----------	-------------------------	---------	--------	---------	---------	--------	---------	---------	--------	---------

All amounts reflected under the "Total remuneration" columns include an amount of R40 000 per annum determined in this Proclamation as the amount to which section 8(1)(d) of the Income Tax Act, 1962, applies.

SCHEDULE 2	
GRADE	OFFICE
Grade F	Minister (National Executive Authority) Premier of a Province Speaker: National Assembly Chairperson: National Council of Provinces (NCOP)
Grade E1	Deputy Minister (National Executive Authority) Deputy Speaker: National Assembly Deputy Chairperson: NCOP Member of the Executive Council of a Province Speaker: Provincial Legislature
Grade E2	Parliamentary Counsellor: President Chief Whip: Majority Party in National Assembly Chief Whip of NCOP Leader of the Opposition in terms of section 57(2)(d) of the Constitution.
Grade D	Parliamentary Counsellor: Deputy President Deputy Speaker: Provincial Legislature
Grade C1	Chairperson of a Committee of a House of Parliament or a Joint Committee Chairperson of a Committees of a House of Parliament Chief Whip of Majority party: Provincial Legislature
Grade C2	Chief Whip: Official Opposition/Largest Minority Party in a House of Parliament Deputy Chief Whip: Majority Party in a House of Parliament Deputy Chairperson of Committees of a House of Parliament Leader of Opposition in terms of section 116(2)(d) of the Constitution: Provincial Legislature Chairperson of a Committee of a Provincial Legislature Chairperson of Committees: Provincial Legislature
Grade B	Leader of a House of Parliament Whip in a House of Parliament Leader of a Minority Party other than the Official Opposition where that Leader is a member of the National Assembly or a permanent delegate to the NCOP Chief Whip of Official Opposition/Largest Minority Party: Provincial Legislature Deputy Chief Whip of Majority Party: Provincial Legislature. Deputy Chairperson of Committees: Provincial Legislature
Grade A1	Member of the National Assembly Permanent Delegate to the NCOP Leader of Provincial Legislature Whip: Provincial Legislature Leader of a Minority Party in a Provincial Legislature other than the Official Opposition
Grade A2	Member of a Provincial Legislature

No. 45, 2005**REMUNERATION OF CONSTITUTIONAL COURT JUDGES AND JUDGES**

- 1 In terms of section 2 of the Judges' Remuneration and Conditions of Employment Act, 2001 (Act No 47 2001) (hereinafter referred to as the Judges' Remuneration Act); I hereby determine the rate, as contained in the attached Schedule, at which salaries are payable to Constitutional Court Judges and Judges annually, with effect from 1 April 2005.
- 2 In terms of section 2(1) of the Judges Remuneration Act, I further determine that an annual allowance of R3 500.00 shall be payable to Constitutional Court Judges and Judges.
- 3 Proclamation No. 57 of 2004, published in Government Gazette No 26968 of 5 November 2004, is hereby repealed.

Given under my Hand at Pretoria on this Twenty-second day of August, Two Thousand and Five.

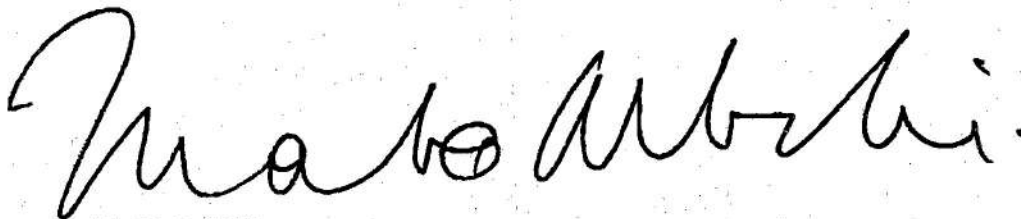
A handwritten signature in black ink, appearing to read 'Mabo Mbohi', written in a cursive style.

PRESIDENT

SCHEDULE	
REMUNERATION OF CONSTITUTIONAL COURT JUDGES AND JUDGES WITH EFFECT FROM	
1-Apr-05	
DESIGNATION OF OFFICE	SALARY PER ANNUM (R)
Chief Justice of South Africa	728 128
Deputy Chief Justice	715 853
President of the Supreme Court of Appeal	715 853
Deputy President of the Supreme Court of Appeal	704 375
Judge of the Constitutional Court	670 270
Judge of the Supreme Court of Appeal	670 270
Judge President of the High Court	666 170
Judge President of the Labour Court	666 179
Deputy Judge President of the High Court	655 450
Deputy Judge President of Labour Court	655 450
Judge of the High Court	650 500
Judge of the Labour Court	650 500

No. 46, 2005**SALARIES, ALLOWANCES AND BENEFITS OF MAGISTRATES**

- 1 In terms of section 12 of the Magistrates Act, 1993, (Act No 90 of 1993); I hereby determine the rate, as contained in the attached Schedule, at which salaries and allowances are payable to Magistrates annually, with effect from 1 April 2005.
- 2 The benefits and allowances payable in terms of this Proclamation shall be subject to the Conditions Applicable To All ranks of Magistrates In Respect of Allowances and Benefits attached hereto.
- 3 Proclamation No. 53 of 2004, published in Government Gazette No 26968 of 5 November 2004, is hereby repealed.

Given under my Hand at Pretoria on this Twenty-second day of August, Two Thousand and Five.

A large, stylized handwritten signature in black ink, appearing to read 'Mabo Mbohi'.

PRESIDENT

SCHEDULE			
REMUNERATION OF MAGISTRATES WITH EFFECT FROM 01 APRIL 2005			
DESIGANTION OF OFFICE	SALARY PER ANNUM (R)	MOTOR VEHICLE ALLOWANCE	TOTAL REMUNERATION
Special Grade Chief Magistrate	411 305	126 736	538 041
Regional Court President	411 305	126 736	538 041
Chief Magistrate	332 226	103 484	435 710
Regional Magistrate	332 226	103 484	435 710
Senior Magistrate	300 589	75 147	375 736
Magistrate	273 444	68 361	341 805

CONDITIONS APPLICABLE TO ALL RANKS OF MAGISTRATES IN RESPECT OF ALLOWANCES AND BENEFITS

1. ANNUAL SERVICE BONUS

The service bonus of a magistrate is the service bonus, including the requirements, conditions and circumstances, which are applicable to a deputy director in the Public Service: Provided that the basis of calculation shall be on the magistrate's annual basic salary at the date on which he or she qualifies for payment.

2. MOTOR VEHICLE FINANCING BENEFIT FOR CHIEF MAGISTRATE, REGIONAL MAGISTRATE AND REGIONAL COURT PRESIDENT AND SPECIAL GRADE CHIEF MAGISTRATE

The annual motor vehicle financing benefit of a person occupying a rank of a Magistrate is as set out in the Schedule, payable in twelve monthly installments on the date on which he or she qualifies for payment of salary, subject to the following conditions:

- a. The motor vehicle financing benefit shall not apply to any magistrate who is not permanently appointed.
- b. A maximum of seventy percent of the motor vehicle financing benefit may be utilized to fund the capital and interest for the purchase or lease of a reliable motor vehicle.
- c. A magistrate shall maintain a reliable motor vehicle to be utilized for official journeys.
- d. A magistrate shall at all times have his or her motor vehicle (or a reliable substitute) available for official journeys.
- e. (e) A chief magistrate or regional court president, or his or her delegate, as the case may be, shall decide whether a magistrate may utilize his or her motor vehicle for any specific official journey(s) or make use of the provisions of public or official transport, taking into account practical implications, cost effectiveness, road conditions etc.
- f. A magistrate shall secure his or her own financing of loans for the purchase or lease of a reliable motor vehicle. Should a magistrate not be able to successfully secure a loan or lease, he or she may through the Department apply for a guarantee from the National Treasury in order to secure a loan or lease.
- g. A magistrate shall at his or her own expense obtain and maintain comprehensive insurance on the motor vehicle, and is fully responsible for all running and maintenance costs and the cost of registration and licensing of the motor vehicle.

- h. A magistrate shall not simultaneously participate in any other Motor Finance Scheme or subsidised motor transport scheme.
- i. A magistrate who participates in the subsidised motor transport scheme shall not receive the motor vehicle financing benefit until such time that his or her contract under the subsidised motor transport scheme has been terminated at his or her request with the approval of and subject to the conditions that the Director-General: Justice and Constitutional Development may stipulate.
- j. A magistrate receiving the Motor Car Finance Benefit in terms of Government Notice R.1416 dated 22 December 2000 shall receive the motor vehicle financing benefit as from 1 July 2001 provided that he or she repays to the Department all basic and supplementary allowances received under the Motor Car Financing Benefit since 1 July 2001.
- k. If a magistrate utilizes his or her motor vehicle to travel for official purposes away from his or her usual place of work, the Department shall reimburse toll fees, and parking fees in excess of R10 per month. The member is responsible for parking fees (if levied) at his or her usual place of work.
- l. If a magistrate uses his or her motor vehicle to carry out official duties, the Department will compensate the magistrate for kilometers travelled in excess of 500 kilometres per month, according to the tariffs payable for privately owned motor vehicles as prescribed by the Department of Transport.
- m. Any journey between a magistrate's home and usual place of work constitutes a private journey.

3. HOME OWNER'S AND MEDICAL AID ALLOWANCE

The home owner's and medical aid allowance of a magistrate is the allowance, including the requirements, conditions, circumstances, and basis of calculations, which is applicable to a deputy director in the Public Service as amended from time to time.



Sabinet Online Ltd has established itself, for more than a decade, as a leader in facilitating electronic access to gazetted information.

Are you looking for information published in Gazettes such as changes to Acts, Regulations of Acts, Notices, Liquidation & distribution accounts on deceased estates?

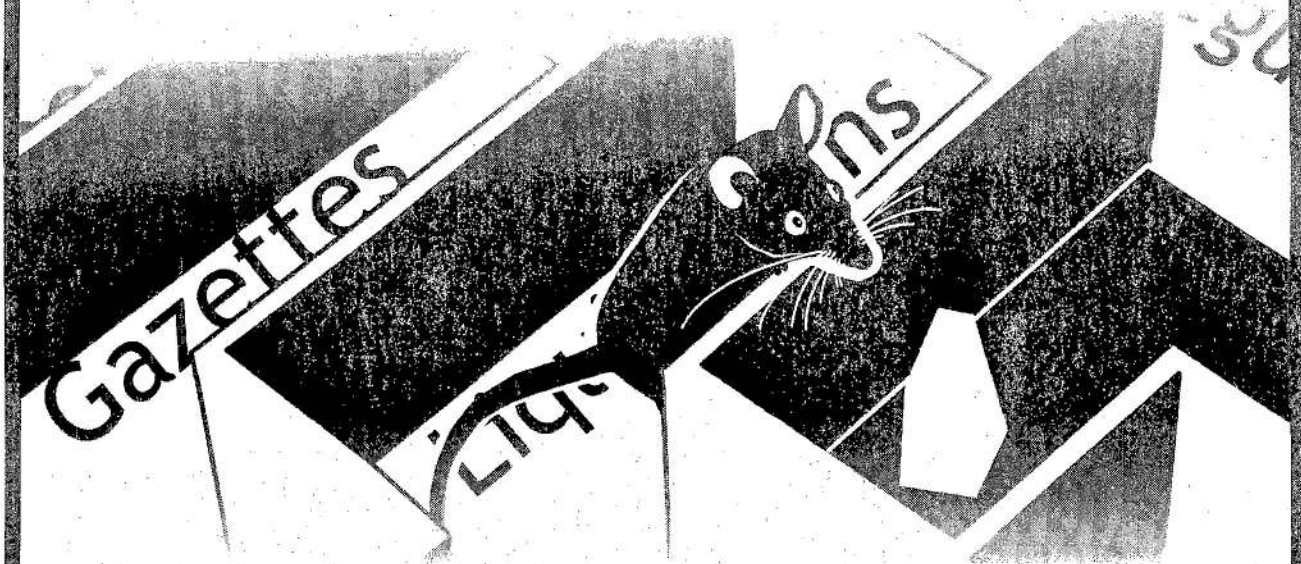

Search no more.

Sabinet Online's SA Gazettes provides immediate access to full-text databases of Government and Provincial Gazettes, the Government Gazette Index and Parliamentary Bills. Updated daily.

The SA Gazettes is considered in all industry sectors as the most comprehensive collection of searchable gazette data on the Internet. With SA Gazettes you have access to the electronic full-text of the Government Gazette and all Provincial Gazettes.

- The Government Gazette - from January 1994
- All Provincial Gazettes - from September 1995
- Indexes pertaining to the past week's Government and all Provincial Gazettes.
- Parliamentary Bills - from January 1999

We facilitate access to information
www.sabinet.co.za

Tel: +27 12 643 9500; Fax: +27 12 663 3543; E-mail: info@sabinet.co.za



Looking for out of print issues of Government and Provincial Gazettes

We can provide photocopies

Contact

The National Library of South Africa,
Pretoria Campus
PO Box 397
0001 PRETORIA

Physical address

C/o Andries and Vermeulen Streets
Entrance in Andries Street

Contact details

Tel: (012) 321-8931
Fax: (012) 325-5984
E-mail: infodesk@nlsa.ac.za

Wetlands are wonderlands!

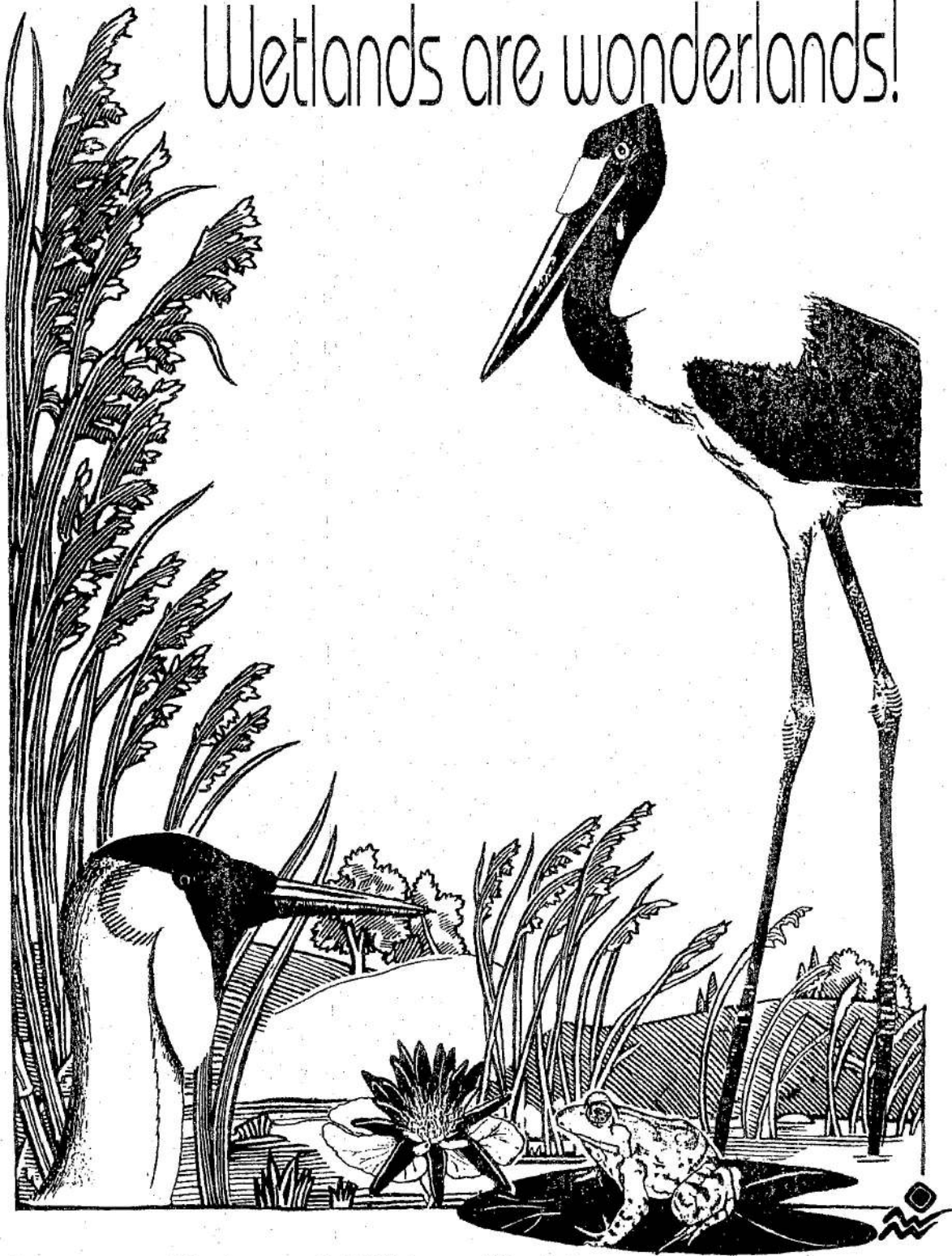

Department of Environmental Affairs and Tourism

THE WEATHER BUREAU HELPS FARMERS TO PLAN THEIR CROP



THE WEATHER BUREAU: DEPARTMENT OF ENVIRONMENTAL AFFAIRS & TOURISM
DIE WEERBURO: DEPARTEMENT VAN OMGEWINGSKE EN TOERISME

SA WEATHER BUREAU SA WEERBURO

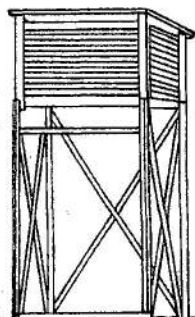
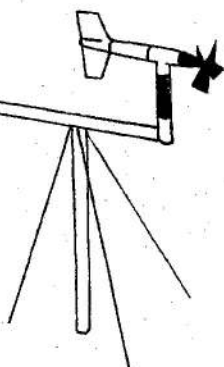

**W
E
A
T
H
E
R
·
S
E
R
V
I
C
E
S
·
W
E
E
R
D
I
E
N
S
T
E**

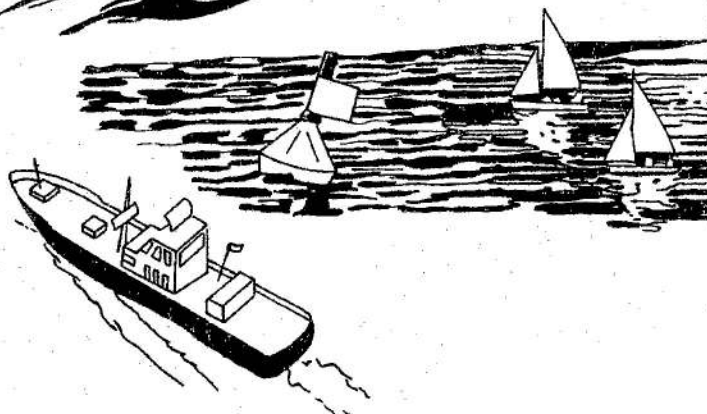
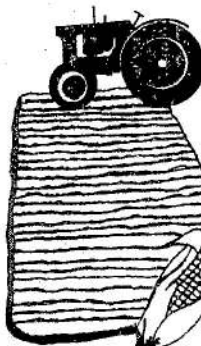
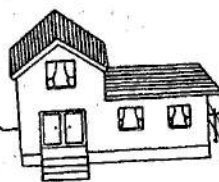
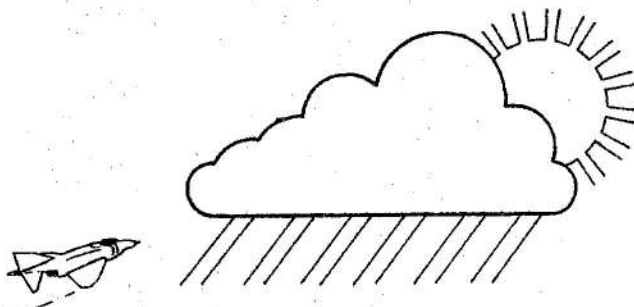

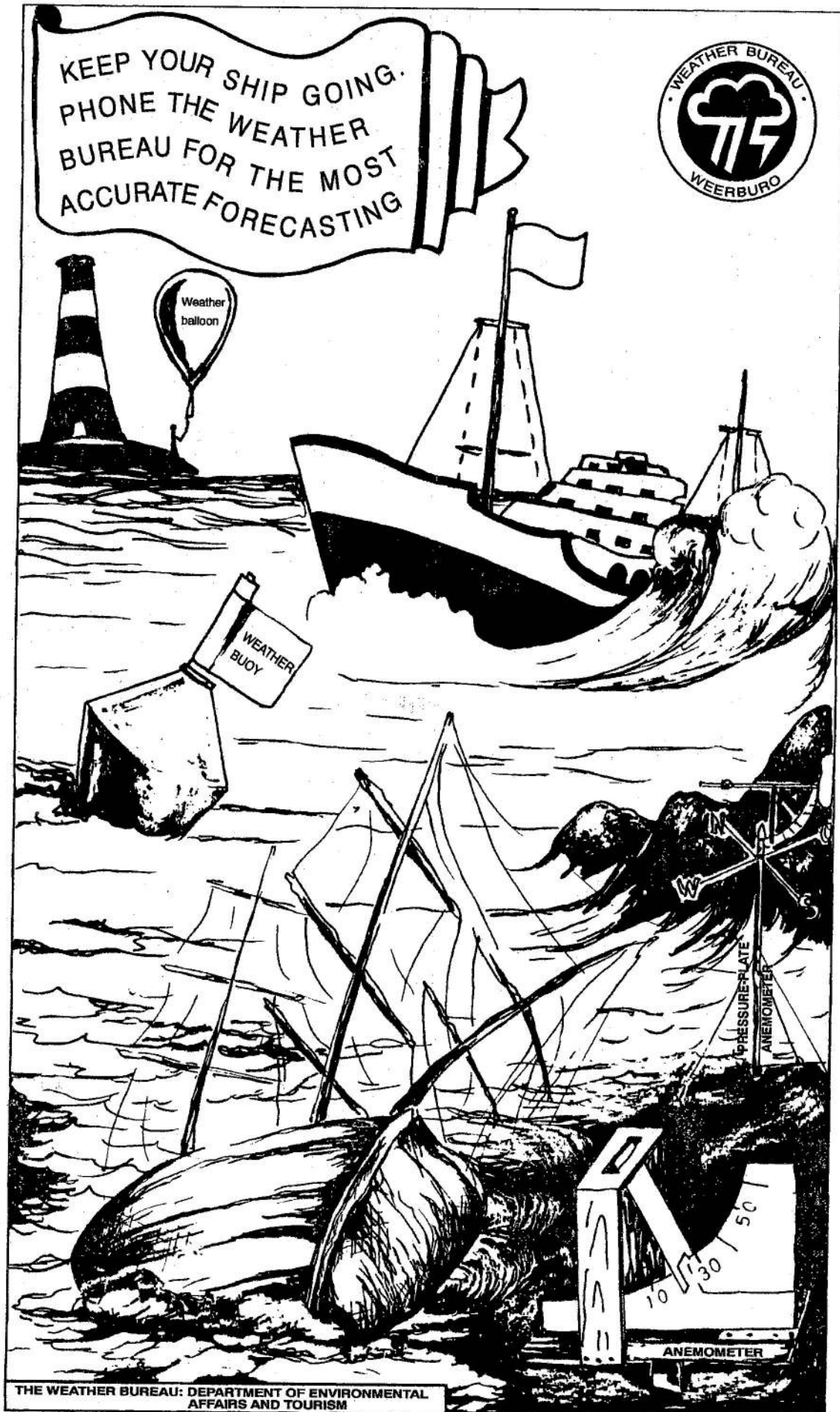

Printed by and obtainable from the Government Printer, Bosman Street, Private Bag X85, Pretoria, 0001

Publications: Tel: (012) 334-4508, 334-4509, 334-4510

Advertisements: Tel: (012) 334-4673, 334-4674, 334-4504

Subscriptions: Tel: (012) 334-4735, 334-4736, 334-4737

Cape Town Branch: Tel: (021) 465-7531

Gedruk deur en verkrygbaar by die Staatsdrukker, Bosmanstraat, Privaatsak X85, Pretoria, 0001

Publikasies: Tel: (012) 334-4508, 334-4509, 334-4510

Advertensies: Tel: (012) 334-4673, 334-4674, 334-4504

Subskripsies: Tel: (012) 334-4735, 334-4736, 334-4737

Kaapstad-tak: Tel: (021) 465-7531