

REPUBLIC OF SOUTH AFRICA
REPUBLIEK VAN SUID-AFRIKA

Vol. 534

Pretoria, 31 December 2009
Desember

No. 32837

For purposes of reference, all Proclamations, Government Notices, General Notices and Board Notices published are included in the following table of contents which thus forms a weekly index. Let yourself be guided by the Gazette numbers in the righthand column:

CONTENTS

and weekly Index

No.		Page No.	Gazette No.
PROCLAMATIONS			
88	Protection of Constitutional Democracy against Terrorist and Related Activities Act (33/2004): Notification by President in respect of entities identified by the United Nations Security Council	3	32824
89	do.: do	9	32824
90	do.: do	14	32824
GOVERNMENT AND GENERAL NOTICES			
Agriculture, Forestry and Fisheries, Department of			
<i>General Notice</i>			
1662	Animal Diseases Act (35/1984): Publication of notice on the consideration to import sable antelope from Zambia to South Africa according to guidelines of the attached protocol	3	32831
Arts and Culture, Department of			
<i>Government Notice</i>			
1247	National Heritage Resources Act (25/1999): Declaration of Farm 1341 a part of The Cape Winelands Cultural Landscape, Daljosafat Cultural Landscape as a national heritage site	6	32837
Communications, Department of			
<i>General Notice</i>			
1661	Broadcasting Act (4/1999): Appointment of non-executive members to the Board of the South African Broadcasting Corporation	3	32828
Co-operative Governance and Traditional Affairs, Department of			
<i>Government Notices</i>			
R. 1225	Remuneration of Public Office Bearers Act (20/1998): Determination of upper limits of salaries, allowances and benefits of different members of municipal councils	3	32833
R. 1242	Notice of correction: Determination of upper limits of salaries, allowances and benefits of different members of municipal councils	2	32817
Energy, Department of			
<i>Government Notice</i>			
1243	Electricity Regulation Act, 2006: Determination regarding the Integrated Resource Plan and new generation capacity	9	32837
Finance, Department of			
<i>Government Notices</i>			
1203	South African Reserve Bank Act (90/1989): The dimension of, design for, and compilation of the year 2010 Natura pure gold coin series	5	32813

Alle Proklamasies, Goewermentskennisgewings, Algemene Kennisgewings en Raadskennisgewings gepubliseer, word vir verwysingsdoeleindes in die volgende Inhoudsopgawe ingesluit wat dus 'n weeklikse indeks voorstel. Laat uself deur die Koerantnommers in die regterhandse kolom lei:

INHOUD

en weeklikse Indeks

No.		Bladsy No.	Koerant No.
PROKLAMASIES			
88	Wet op die Beskerming van Konstitusionele Demokrasie teen Terroriste- en Verwante Aktiwiteite (33/2004): Kennisgewing deur President ten opsigte van entiteite deur Veiligheidsraad van Verenigde Nasies geïdentifiseer	5	32824
89	do.: do	11	32824
90	do.: do	16	32824
GOEWERMENTS- EN ALGEMENE KENNISGEWINGS			
Energie, Departement van			
<i>Goewermentskennisgewing</i>			
1243	Electricity Regulation Act, 2006: Determination regarding the Integrated Resource Plan and new generation capacity	9	32837
Finansies, Departement van			
<i>Goewermentskennisgewings</i>			
1203	South African Reserve Bank Act (90/1989): The dimension of, design for, and compilation of the year 2010 Natura pure gold coin series	5	32813
1204	do.: The dimension of, design for, and compilation of the year 2010 Protea coin series	7	32813
1205	do.: The dimension of, design for, and compilation of the year 2010 Crown size and 2 1/2, sterling silver coin series	9	32813
1206	do.: The dimension of, design for, and compilation of the year 2010 sterling silver coin series	11	32813
1207	do.: The dimension of, design for, and compilation of the year 2010 "FIFA 2010 coin series"	13	32813
Gesondheid, Departement van			
<i>Goewermentskennisgewing</i>			
R. 1215	Medical Schemes Act (131/1998): Regulations: Amendment: Therapeutic algorithms for chronic conditions	3	32823
Handel en Nywerheid, Departement van			
<i>Goewermentskennisgewing</i>			
1246	Standards Act (8/2008): Standards matters	14	32837
<i>Algemene Kennisgewings</i>			
1663	Companies Act (71/2008): Rectification: For comments	3	32832
1664	do.: Companies regulations pursuant to the Act: For public comments	8	32832
Kommunikasie, Departement van			
<i>Algemene Kennisgewing</i>			
1661	Broadcasting Act (4/1999): Appointment of non-executive members to the Board of the South African Broadcasting Corporation	3	32828

No.		Page No.	Gazette No.	No.		Bladsy No.	Koerant No.
1204	South African Reserve Bank Act (90/1989): The dimension of, design for, and compilation of the year 2010 Protea coin series	7	32813	Kuns en Kultuur, Departement van			
1205	do.: The dimension of, design for, and compilation of the year 2010 Crown size and 2 1/2, sterling silver coin series	9	32813	<i>Goewermentskennisgewing</i>			
1206	do.: The dimension of, design for, and compilation of the year 2010 sterling silver coin series	11	32813	1247	National Heritage Resources Act (25/1999): Declaration of Farm 1341 a part of The Cape Winelands Cultural Landscape, Daljosafat Cultural Landscape as a national heritage site	6	32837
1207	do.: The dimension of, design for, and compilation of the year 2010 "FIFA 2010 coin series"	13	32813	Landbou, Bosbou en Visserye, Departement van			
Health, Department of				<i>Algemene Kennisgewing</i>			
<i>Government Notice</i>				1662	Animal Diseases Act (35/1984): Publication of notice on the consideration to import sable antelope from Zambia to South Africa according to guidelines of the attached protocol	3	32831
R. 1215	Medical Schemes Act (131/1998): Regulations: Amendment: Therapeutic algorithms for chronic conditions	3	32823	Minerale Bronne, Departement van			
Independent Communications Authority of South Africa				<i>Goewermentskennisgewings</i>			
<i>General Notice</i>				1244	Mines and Works Act (27/1956): Declaration of work in national interest: Penumbra Opencast	12	32837
1659	Independent Broadcasting Authority Act (153/1993): Findings document on the review of the 1999 Regulations relating to Advertising, Infomercials and Programme Sponsorship	3	32826	1245	do.: do.: Mogalakwena Platinum Mine	13	32837
Mineral Resources, Department of				Onafhanklike Kommunikasie-owerheid van Suid-Afrika			
<i>Government Notices</i>				<i>Algemene Kennisgewing</i>			
1244	Mines and Works Act (27/1956): Declaration of work in national interest: Penumbra Opencast	12	32837	1659	Independent Broadcasting Authority Act (153/1993): Findings document on the review of the 1999 Regulations relating to Advertising, Infomercials and Programme Sponsorship	3	32826
1245	do.: do.: Mogalakwena Platinum Mine	13	32837	Polisie, Departement van			
Police, Department of				<i>Goewermentskennisgewing</i>			
<i>Government Notice</i>				1223	Control of Access to Public Premises and Vehicles Act (53/1985): Declaration of Bombela Operating Company (Pty) Ltd to be a statutory body for purposes of the Act	3	32829
1223	Control of Access to Public Premises and Vehicles Act (53/1985): Declaration of Bombela Operating Company (Pty) Ltd to be a statutory body for purposes of the Act	3	32829	Samewerkende Regering en Tradisionele Sake, Departement van			
South African Qualifications Authority				<i>Goewermentskennisgewings</i>			
<i>Government Notices</i>				R. 1225	Remuneration of Public Office Bearers Act (20/1998): Determination of upper limits of salaries, allowances and benefits of different members of municipal councils	3	32833
1216	National Standards Bodies Regulations: Standards Generating Body (SGB) for Manufacturing and Assembly Processes	3	32822	R. 1242	Notice of correction: Determination of upper limits of salaries, allowances and benefits of different members of municipal councils	2	32817
1217	do.: Task Team for Public Prosecuting	17	32822	Suid Afrikaanse Inkomstediens			
1218	do.: Task Team for Human Trafficking	35	32822	<i>Goewermentskennisgewings</i>			
1219	do.: Task Team for Occupational Health and Safety	40	32822	R. 1221	Doeane- en Aksynswet, 1964: Wysiging van Bylae No. 1 (No. 1/1/1395)	6	32825
1220	do.: Task Team for Medical Technology ..	56	32822	R. 1222	do.: Wysiging van Bylae No. 1 (No. 1/1/1394)	70	32825
South African Reserve Bank				R. 1224	Customs and Excise Act, 1964: Amendment of Rules (DAR/66)	3	32830
<i>General Notice</i>				Suid-Afrikaanse Kwalifikasie-owerheid			
1668	Currency and Exchanges Act (9/1933): Notice and Order of Forfeiture	33	32837	<i>Goewermentskennisgewings</i>			
South African Revenue Service				1216	National Standards Bodies Regulations: Standards Generating Body (SGB) for Manufacturing and Assembly Processes	3	32822
<i>Government Notices</i>				1217	do.: Task Team for Public Prosecuting	17	32822
R. 1221	Customs and Excise Act, 1964: Amendment of Schedule No. 1 (No. 1/1/1395)	3	32825	1218	do.: Task Team for Human Trafficking	35	32822
R. 1222	do.: Amendment of Schedule No. 1 (No. 1/1/1394)	9	32825				
R. 1224	Customs and Excise Act, 1964: Amendment of Rules (DAR/66)	3	32830				

No.	Page No.	Gazette No.	No.	Bladsy No.	Koerant No.
Trade and Industry, Department of			1219	National Standards Bodies Regulations: Task Team for Occupational Health and Safety	
<i>Government Notice</i>				40	32822
1246	Standards Act (8/2008): Standards matters	14 32837	1220	do.: Task Team for Medical Technology ..	
				56	32822
<i>General Notices</i>			Suid-Afrikaanse Reserwebank		
1663	Companies Act (71/2008): Rectification: For comments	3 32832	<i>Algemene Kennisgewing</i>		
1664	do.: Companies regulations pursuant to the Act: For public comments	8 32832	1668	Currency and Exchanges Act (9/1933): Notice and Order of Forfeiture	
				33	32837
Transport, Department of			Vervoer, Departement van		
<i>General Notice</i>			<i>Algemene Kennisgewing</i>		
1667	Air Traffic and Navigation Services Company Act (45/1993): Publication of air traffic service charges	20 32837	1667	Air Traffic and Navigation Services Company Act (45/1993): Publication of air traffic service charges	
				20	32837

IMPORTANT ANNOUNCEMENT

Closing times **PRIOR TO PUBLIC HOLIDAYS** for GOVERNMENT NOTICES, GENERAL NOTICES, REGULATION NOTICES AND PROCLAMATIONS **2009**

The closing time is 15:00 sharp on the following days:

- ▶ 30 December, Thursday, for the issue of Friday 8 January 2010
- ▶ 18 March, Thursday, for the issue of Friday 26 March 2010
- ▶ 25 March, Thursday, for the issue of Thursday 1 April 2010
- ▶ 31 March, Wednesday, for the issue of Friday 9 April 2010
- ▶ 22 April, Thursday, for the issue of Friday 30 April 2010
- ▶ 10 June, Thursday, for the issue of Friday 18 June 2010
- ▶ 5 August, Thursday, for the issue of Friday 13 August 2010
- ▶ 16 September, Thursday, for the issue of Thursday 23 September 2010
- ▶ 23 September, Thursday, for the issue of Friday 1 October 2010
- ▶ 9 December, Thursday, for the issue of Friday 17 December 2010
- ▶ 15 December, Wednesday, for the issue of Friday 24 December 2010
- ▶ 21 December, Tuesday, for the issue of Friday 31 December 2010
- ▶ 30 December, Thursday, for the issue of Friday 7 January 2011

Late notices will be published in the subsequent issue, if under special circumstances, a late notice is accepted, a double tariff will be charged

The copy for a SEPARATE Government Gazette must be handed in not later than three calendar weeks before date of publication

BELANGRIKE AANKONDIGING

Sluitingstye **VOOR VAKANSIEDAE** vir GOEWERMENTS-, ALGEMENE- & REGULASIE- KENNISGEWINGS ASOOK PROKLAMASIES **2009**

Die sluitingstyd is stiptelik 15:00 op die volgende dae:

- ▶ 30 Desember, Woensdag, vir die uitgawe van Vrydag 8 Januarie 2010
- ▶ 18 Maart, Donderdag, vir die uitgawe van Vrydag 26 Maart 2010
- ▶ 25 Maart, Donderdag, vir die uitgawe van Donderdag 1 April 2010
- ▶ 31 Maart, Woensdag, vir die uitgawe van Vrydag 9 April 2010
- ▶ 22 April, Donderdag, vir die uitgawe van Vrydag 30 April 2010
- ▶ 10 Junie, Donderdag, vir die uitgawe van Vrydag 18 Junie 2010
- ▶ 5 Augustus, Donderdag, vir die uitgawe van Vrydag 13 Augustus 2010
- ▶ 16 September, Donderdag, vir die uitgawe van Donderdag 23 September 2010
- ▶ 23 September, Donderdag, vir die uitgawe van Vrydag 1 Oktober 2010
- ▶ 9 Desember, Donderdag, vir die uitgawe van Vrydag 17 Desember 2010
- ▶ 15 Desember, Woensdag, vir die uitgawe van Vrydag 24 Desember 2010
- ▶ 21 Desember, Dinsdag, vir die uitgawe van Vrydag 31 Desember 2010
- ▶ 30 Desember, Donderdag, vir die uitgawe van Vrydag 7 Januarie 2011

Laat kennisgewings sal in die daaropvolgende uitgawe geplaas word. Indien 'n laat kennisgewing wel, onder spesiale omstandighede, aanvaar word, sal 'n dubbeltarief gehef word

Wanneer 'n APARTE Staatskoerant verlang word moet die kople drie kalenderweke voor publikasie ingedien word

GOVERNMENT NOTICES GOEWERMENTSKENNISGEWINGS

DEPARTMENT OF ARTS AND CULTURE
DEPARTEMENT VAN KUNS EN KULTUUR

No. 1247

31 December 2009

SOUTH AFRICAN HERITAGE RESOURCES AGENCY

GOVERNMENT GAZETTE NOTICE FOR THE DECLARATION OF FARM 1341 (incl the FARMS KNOWN AS THE FARMS ROGGE LAND, NON PAREILLE AND GOEDE RUST), A PART OF THE CAPE WINELANDS CULTURAL LANDSCAPE, DALJOSAFAT CULTURAL LANDSCAPE, TO BE PUBLISHED IN THE GOVERNMENT GAZETTE AS A NATIONAL HERITAGE SITE

DECLARATION OF FARM 1341 a part of THE CAPE WINELANDS CULTURAL LANDSCAPE, DALJOSAFAT CULTURAL LANDSCAPE AS A NATIONAL HERITAGE SITE

By virtue of the powers vested in the South African Heritage Resources Agency (SAHRA) in terms of section 27 (5) of the National Heritage Resources Act no 25 of 1999 (the act), SAHRA hereby declares A PART OF THE CAPE WINELANDS CULTURAL LANDSCAPE, identified as FARM 1341, a portion DALJOSAFAT CULTURAL LANDSCAPE IN THE DISTRICT OF PAARL, WESTERN CAPE PROVINCE AS A NATIONAL HERITAGE SITE.

STATEMENT OF SIGNIFICANCE

The Daljosafat Cultural Landscape is significant because of its idyllic setting, rich history associated with living heritage and a distinctive cultural and natural environment. It boasts a distinct Cape Vernacular Architecture with an aesthetic landscape design, unique to South Africa. Further significant features of the site are that it remains untouched, unaltered and it is authentic in its rural simplicity. The site exudes qualities less evident in other landscapes of its kind and exhibits magnificent cultural treasures ranging from fine historic monuments, rich social and

linguistic history, with significant farmscapes with a Cape Vernacular Architectural tradition, to routes of scenic value with unspoilt views of the iconic Hawekwas and Klein Drakenstein mountain ranges as a backdrop.

The architectural design is predominantly in the Cape Dutch style, albeit that some of the buildings denotes architectural interventions of subsequent historic period.

The following properties are hereby included as Daljosafat Cultural Landscape National Heritage Site:

DESCRIPTION

The following property falls within the protected area:

	ERF NOS.	SITE NAME	OWNER	TITLE DEED	EXTENT
1	1341	Farm 1341	South African Heritage Resources Agency	T13262/1986 T34969/2007	232.5850

SUBJECT	FOOTPRINT	SPECIALTY	REMARKS	INITIALS	DATES
000000	000000		7-16-89 11:15 AM - 11:30 AM Initialing all Special Agents to		

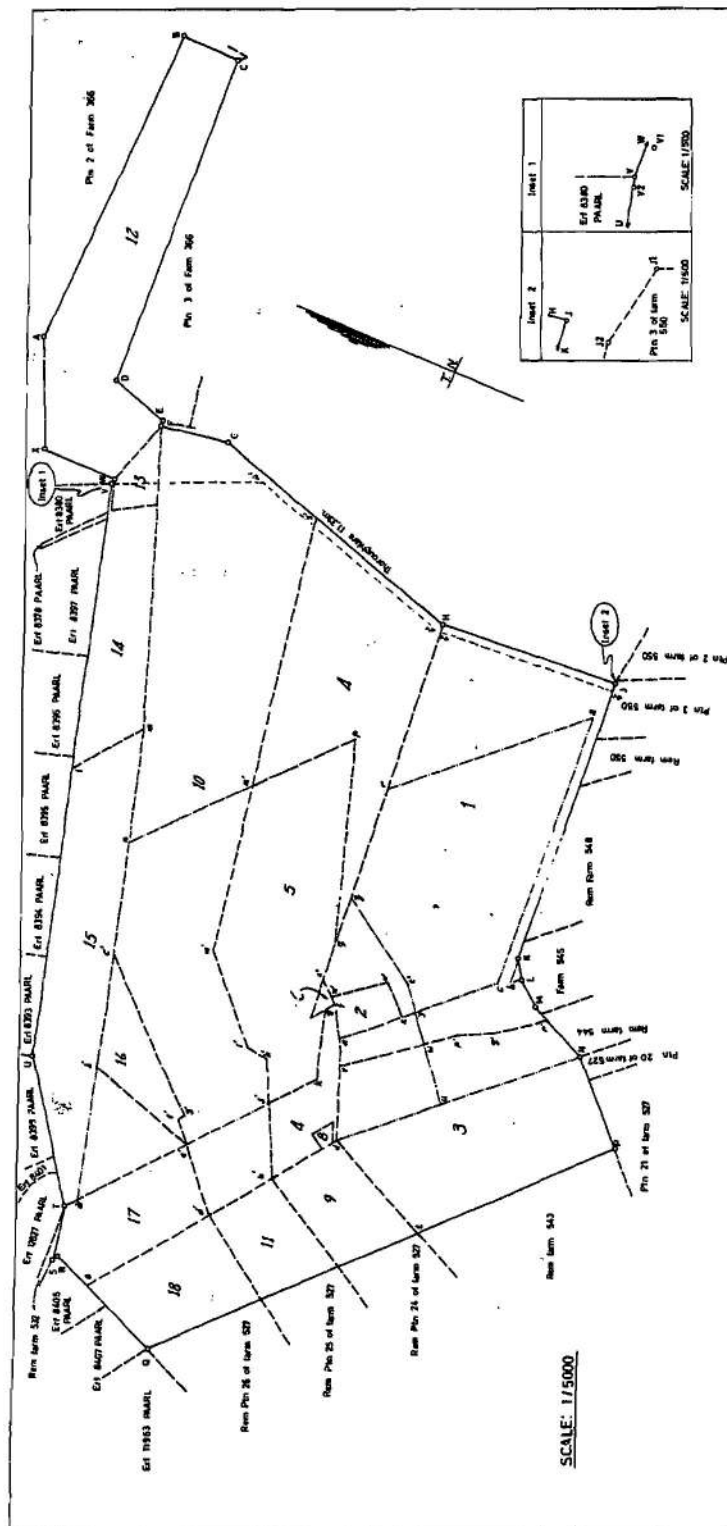

SCALE: 1/5000

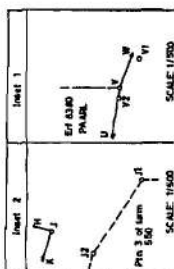
[illegible]

DESCRIPTION OF BEACONS

A	Iron rail in concrete
B	20mm round iron peg in carn. Concentrated
C	Iron rail
D	Iron standard projecting 750mm.
E	Granda round iron peg in concrete
F	Granda round iron peg in concrete
G	Conical industry section
H	Iron standard in carn. Concentrated
I	Pinned round iron peg concentrated in old
J	Iron standard building iron side fence
K	Iron standard building ground level
L	Iron standard in concrete

[illegible]

The square represents
 272,9650 Ha. of land being

100-443887-100

Report number	772, 5650 Ma.	of land being
1		
2		
3		
4		
5		
6		
7		
8		
9		
10		
11		
12		
13		
14		
15		
16		
17		
18		
19		
20		
21		
22		
23		
24		
25		
26		
27		
28		
29		
30		
31		
32		
33		
34		
35		
36		
37		
38		
39		
40		
41		
42		
43		
44		
45		
46		
47		
48		
49		
50		
51		
52		
53		
54		
55		
56		
57		
58		
59		
60		
61		
62		
63		
64		
65		
66		
67		
68		
69		
70		
71		
72		
73		
74		
75		
76		
77		
78		
79		
80		
81		
82		
83		
84		
85		
86		
87		
88		
89		
90		
91		
92		
93		
94		
95		
96		
97		
98		
99		
100		

Form 1241 Compulsory 1 to 17 absolute

Part	Province of Cape of Good Hope	Administrative District
1		
2		
3		
4		
5		
6		
7		
8		
9		
10		
11		
12		
13		
14		
15		
16		
17		
18		
19		
20		
21		
22		
23		
24		
25		
26		
27		
28		
29		
30		
31		
32		
33		
34		
35		
36		
37		
38		
39		
40		
41		
42		
43		
44		
45		
46		
47		
48		
49		
50		
51		
52		
53		
54		
55		
56		
57		
58		
59		
60		
61		
62		
63		
64		
65		
66		
67		
68		
69		
70		
71		
72		
73		
74		
75		
76		
77		
78		
79		
80		
81		
82		
83		
84		
85		
86		
87		
88		
89		
90		
91		
92		
93		
94		
95		
96		
97		
98		
99		
100		

Surveyed in April - July 1980

1950

Land Surveyor

This diagram is annexed to
C.C. V
No. 43-16/1

5.1.1 No. E 1411/2489
Comp. BH- 0230 (2730)

	01 - 5 CAD (367)	01 - 5 CCA (367)
Market Grant		
Hls		

Signature of Director	BA - (609) 426-3333
-----------------------	---------------------

**DEPARTMENT OF ENERGY
DEPARTEMENT VAN ENERGIE****No. 1243****31 December 2009****NOTICE****ELECTRICITY REGULATION ACT, 2006****DETERMINATION REGARDING THE INTEGRATED RESOURCE PLAN AND NEW
GENERATION CAPACITY**

I, Dipuo Peters, Minister of Energy hereby approve the attached Integrated Resource Plan (IRP1 in **Schedule A**) for implementation as per the requirement of the electricity regulations on new generation capacity (Regulation No. 9116, dated 05 August 2009). The attached IRP also takes into account energy efficiency and demand side management projects.

In line with the IRP, I hereby determine that new generation capacity is required in accordance with Section 34 of the Electricity Regulation Act (Act No. 4 of 2006). The required new generation must be met through the projects listed in the IRP. In respect of energy efficiency, demand side management and renewable energy, **Schedule B** outlines the framework for implementation of such projects.



Ms. Dipuo Peters
MINISTER OF ENERGY
DATE **16/12/2009**

Schedule A

Integrated Resource Plan (IRP 1)

The IRP gives effect to the following policy objectives:

- (i) 10 000 Gwh (approximately 4% of the energy mix) of renewable energy usage,
- (ii) The implementation of Energy Efficiency and Demand Side Management through financial incentives scheme, and
- (iii) Installation of one million solar water heaters.

In respect of (i), this will be met by licensing the projects in IRP 1 below under the "MTPP", "REFIT" and "Sere and CSP" programmes.

In respect of (ii) and (iii), this will be met through the standard offer programme (demand side management programme in IRP 1) in accordance with the implementation rules developed by the National Energy Regulator of South Africa.

In addition, projects in IRP 1 below that predate the electricity regulations on new generation capacity may be licensed.

Projects listed in IRP 1 must comply with the codes and rules prescribed by the National Energy Regulator of South Africa.

IRP 1

	Current programmes								Total	Total system capacity	Peak demand (net sent-out) forecast				Reserve Margin	Annual energy (net sent-out) forecast		
	RTS capacity	Medupi	Kusile	Ingula	DoE OCGT IPP	MTPPP, REFIT	Sere, CSP	Other capacity and decommissioning			Peak demand (net sent-out) forecast	Demand side management programmes	Net peak demand forecast (after DSM)			Annual energy (net sent-out) forecast	Demand side management programmes	Annual energy (net sent-out) forecast
	MW	MW	MW	MW	MW	MW	MW	MW	MW	MW	MW	MW	MW	%		GWh	GWh	GWh
2009	772	0	0	0	0	0	0	0	772	44157	37845	432	37413	0.1802582		248 517	428	248 089
2010	683	0	0	0	0	343	150	30	1206	45363	39432	923	38509	0.17798437		258 705	1 864	256 840
2011	404	0	0	0	1020	518	0	55	1997	47360	40914	1343	39571	0.19683607		267 771	3 453	264 319
2012	0	738	0	0	0	284	0	0	1022	48382	42373	2118	40255	0.20188796		276 705	6 561	270 145
2013	0	738	723	666	0	0	0	0	2127	50509	44238	3056	41182	0.22648244		288 086	10 542	277 444

The Department will initiate a process of reviewing this IRP to allow for consultation with stakeholders. The process of developing IRP 2 will commence in January 2010.

Schedule B

<i>Project</i>	<i>Initiatives</i>	<i>Time frame</i>
Demand Side Management Programmes	Installation of 1 million solar water heaters in selected areas and in accordance with the Solar Water Heating Framework.	To commence on 1 March 2010
	Implementation of the Standard Offer Framework to provide incentives for demand side management and energy efficiency projects initiated by various developers.	To commence on 1 March 2010
New generation capacity based on the REFIT programme (Construction of new generation plants based on renewable energy technologies)	REFIT programme in respect of the following technologies for which NERSA shall determined the tariffs: (i) concentrated solar (ii) solar photovoltaic (iii) wind (iv) landfill gas (v) solid biomass (vi) small hydro	To commence on 1 March 2010
New generation capacity base on the IPP Bid programme	Note that a determination in respect of other new generation capacity initiatives will be done in due course	

**DEPARTMENT OF MINERAL RESOURCES
DEPARTEMENT VAN MINERALE BRONNE****No. 1244****31 December 2009****MINES AND WORKS ACT, 1956 (ACT No. 27 OF 1956)****DECLARATION OF WORK IN NATIONAL INTEREST**

Under Section 9(1)(f) of the Mines and Works Act, 1956 (Act No. 27 of 1956), I Susan Shabangu, Minister of Mineral Resources, hereby declare that in my opinion the performance of mining operations on Sundays at the mine known as Penumbra Opencast in the district of Ermelo, Province of Mpumalanga, is necessary in the national interest for a period of 3 years from 19 October 2009.

MS S SHABANGU**MINISTER OF MINERAL RESOURCES****DATE: 24/11/2009**

No. 1245

31 December 2009

MINES AND WORKS ACT, 1956
ACT No 27 OF 1956

DECLARATION OF WORK IN THE NATIONAL INTEREST

Under Section 9(1)f) of the Mines and Works Act, 1956 (Act No 27 of 1956), I, Ms S Shabangu, Minister of Mineral resources, hereby declare that, in my opinion, the performance on Sundays work, details of which appear in the schedule hereto, at the mine known as Mogalakwena Platinum Mine in the Magisterial District of Waterberg, Limpopo Province, is necessary in the National interest for a period of twelve months ending 24 October 2010.



MS S SHABANGU

MINISTER OF MINERAL RESOURCES

**DEPARTMENT OF TRADE AND INDUSTRY
DEPARTEMENT VAN HANDEL EN NYWERHEID**

No. 1246

31 December 2009

**STANDARDS ACT, 2008
STANDARDS MATTERS**

In terms of the Standards Act, 2008 (Act No. 8 of 2008), the Council of the South African Bureau of Standards has acted in regard to standards in the manner set out in the Schedules to this notice.

All South African standards that were previously published by the South African Bureau of Standards with the prefix "SABS" have been redesignated as South African national standards and are now published by Standards South Africa (a division of SABS) with the prefix "SANS".

A list of all existing South African national standards was published by Government Notice No. 1373 of 8 November 2002.

In the list of SANS standards below, the equivalent SABS numbers, where applicable, are given below the new SANS numbers for the sake of convenience. Standards that were published with the "SABS" prefix are listed as such.

SCHEDULE 1: ISSUE OF NEW STANDARDS

The standards mentioned have been issued in terms of section 16(3) of the Act.

Standard No. and year	Title, scope and purport
SANS 486:2009	<i>Conveyor belting – Finger splicing of solid woven construction conveyor belting.</i> Specifies the requirements for hot-vulcanised finger splicing of solid woven construction conveyor belting.
SANS 551:2009	<i>Detonators, relays and explosives initiating devices for commercial applications.</i> Covers the following initiation devices and initiation systems: Non-electric detonators, electronic detonators, electric detonators, permitted electric detonators, igniters and relays.
SANS 665-2:2009	<i>Wedge gate and resilient seal valves for general purposes – Part 2: Wedge gate valves.</i> Covers the requirements for the design and construction of wedge gate valves of pressure rating (PN) up to 2.500 kPa and sizes up to 1 000 mm.
SANS 665-3:2009	<i>Wedge gate and resilient seal valves for general purposes – Part 3: Resilient seal valves.</i> Covers the requirements for the design and construction of resilient seal valves of pressure rating (PN) up to 2 500 kPa and sizes up to 600 mm.
SANS 831-1:2009/ ISO 6242-1:1992	<i>Building construction – Expression of users' requirements – Part 1: Thermal requirements.</i> Defines how the thermal requirements of building users can be identified, expressed and quantified.
SANS 1883-1:2009	<i>Geographic information – Addresses – Part 1: Data format of addresses.</i> Specifies and defines the data elements, as well as the address types that can be constructed from the data elements for South African addresses. Defines terms and definitions related to addresses in South Africa. Applies to addresses covering the whole of South Africa. Describes the physical location of a point of service delivery, and addresses that could be geo-referenced. Includes definitions for address types that are assigned by the official address issuing body (such as the street address type), as well as address types that are commonly in use (such as the farm and informal address types).
SANS 1883-3:2009	<i>Geographic information – Addresses – Part 3: Guidelines for address allocation and updates.</i> Provides guidelines for the allocation and maintenance of addresses for the official address types specified in Part 1 of this standard. It gives rules, orientation, advice and recommendations relating to the use of Part 1. It applies to any area where the development correlates with the underlying cadastre, including previously unaddressed areas. Specifies how addresses should be arranged geographically and how addresses should be updated in the case of name changes, boundary changes, subdivisions, and consolidations.
SANS 5725-6:2009/ ISO 5725-6:1994	<i>Accuracy (trueness and precision) of measurement methods and results – Part 6: Use in practice of accuracy values.</i> Given that the accuracy of a measurement method has been established, this document gives information on the application of that knowledge in practical situations in such a way as to facilitate commercial transactions and to monitor and improve the operational performance of laboratories.
SANS 7439:2009/ ISO 7439:2002	<i>Copper-bearing intra-uterine contraceptive devices – Requirements, tests.</i> Applies to single-use copper-bearing intra-uterine contraceptive devices and their insertion instruments.
SANS 7619-2:2009/ ISO 7619-2:2004	<i>Rubber, vulcanized or thermoplastic – Determination of indentation hardness – Part 2: IRHD pocket meter method.</i> Specifies a method for determining the indentation hardness of vulcanized or thermoplastic rubber by means of a pocket hardness meter calibrated in IRHD.
SANS 9177-3:2009/ ISO 9177-3:1994	<i>Mechanical pencils – Part 3: Black leads – Bending strengths of HB leads.</i> Specifies bending strengths and a test method for black leads of HB hardness degree used for mechanical pencils for technical drawings.
SANS 9180:2009/ ISO 9180:1988	<i>Black leads for wood-cased pencils – Classification and diameters.</i> Specifies a classification and diameters for black leads used for wood-cased pencils.
SANS 12756:2009/ ISO 12756:1998	<i>Drawing and writing instruments – Ball point pens and roller ball pens – Vocabulary.</i> Defines terms related to ball-point pens and roller ball pens.
SANS 19138:2009/ ISO/TS 19138:2006	<i>Geographic information – Data quality measures.</i> Defines a set of data quality measures. Defines a set of data quality measures. These can be used when reporting data quality for the data quality subelements identified in ISO 19113 (Published in South Africa as an identical adoption under the designation SANS 19113). Multiple measures are defined for each data quality subelement, and the choice of which to use will depend on the type of data and its intended purpose.

Standard No. and year	Title, scope and purport
SANS 19139:2009/ ISO/TS 19139:2007	<i>Geographic information – Metadata – XML schema implementation.</i> Defines Geographic MetaData XML (gmd) encoding, an XML Schema implementation derived from ISO 19115 (Published in South Africa as an identical adoption under the designation SANS 19115).
SANS 21127:2009/ ISO 21127:2006	<i>Information and documentation – A reference ontology for the interchange of cultural heritage information.</i> Establishes guidelines for the exchange of information between cultural heritage institutions. In simple terms, this can be defined as the curated knowledge of museums.
SANS 23814:2009/ ISO 23814:2009	<i>Cranes – Competency requirements for crane inspectors.</i> Specifies the competency required for persons who carry out periodic, exceptional, alteration and thorough inspections of cranes. It excludes the inspection and checks performed by crane operators and maintenance personnel.
SANS 25062:2009/ ISO/IEC 25062:2006	<i>Software engineering – Software product Quality Requirements and Evaluation (SQuaRE) – Common Industry Format (CIF) for usability test reports.</i> Provides a standard method for reporting usability test findings. The format is designed for reporting results of formal usability tests in which quantitative measurements were collected, and is particularly appropriate for comparative testing.
SANS 27668-1:2009/ ISO 27668-1:2009	<i>Gel ink ball pens and refills – Part 1: General use.</i> Establishes minimum quality requirements for gel ink ball pens (refillable and non-refillable) and refills for general use.
SANS 27668-2:2009/ ISO 27668-2:2009	<i>Gel ink ball pens and refills – Part 2: Documentary use (DOC).</i> Establishes minimum quality requirements for gel ink ball pens (refillable or non-refillable) and refills for documentary use.
SANS 60034-18-42:2009/ IEC/TS 60034-18-42:2008	<i>Rotating electrical machines – Part 18-42: Qualification and acceptance tests for partial discharge resistant electrical insulation systems (Type II) used in rotating electrical machines fed from voltage converters.</i> Defines criteria for assessing the insulation system of stator/rotor windings of single or polyphase AC machines which are subjected to repetitive impulse voltages, such as pulse width modulation (PWM) converters, and expected to withstand partial discharge activity during service. Specifies electrical qualification and acceptance tests on representative samples which verify fitness for operation with voltage-source converters. Does not apply to rotating machines which are fed by converters only for starting, or to electrical equipment and systems for traction.
SANS 60079-31:2009/ IEC 60079-31:2008	<i>Explosive atmospheres – Part 31: Equipment dust ignition protection by enclosure "t".</i> Applicable to electrical equipment protected by enclosure and surface temperature limitation for use in explosive dust atmospheres. Specifies requirements for design, construction and testing of electrical equipment. Does not apply to dusts of explosives, which do not require atmospheric oxygen for combustion, pyrophoric substances, electrical equipment intended for use in underground parts of mines and those parts of surface installations of such mines endangered by firedamp and/or combustible dust. Does not take account of any risk due to an emission of flammable or toxic gas from the dust.
SANS 61000-3-12:2009/ IEC 61000-3-12:2004	<i>Electromagnetic compatibility (EMC) – Part 3-12: Limits – Limits for harmonic currents produced by equipment connected to public low-voltage systems with input current >16 A and ≤75 A per phase.</i> Deals with the limitation of harmonic currents injected into the public supply system. Applies to equipment intended to be connected to low-voltage systems interfacing with the public supply at the low-voltage level.
SANS 61000-5-6:2009/ IEC TR 61000-5-6:2002	<i>Electromagnetic compatibility (EMC) – Part 5-6: Installation and mitigation guidelines – Mitigation of external EM influences.</i> Covers guidelines for the mitigation of external electromagnetic influences impinging upon a facility, aimed at ensuring electromagnetic compatibility (EMC) among electrical and electronic apparatus or systems. Is particularly concerned with the arrangement of shielding and screening against radiated disturbances, and with mitigation of conducted disturbances.
SANS 61000-5-7:2009/ IEC 61000-5-7:2001	<i>Electromagnetic compatibility (EMC) – Part 5-7: Installation and mitigation guidelines – Degrees of protection provided by enclosures against electromagnetic disturbances (EM code).</i> Describes performance requirements, test methods and classification procedure for degrees of protection provided by empty enclosures against electromagnetic disturbances for frequencies between 10 kHz and 40 GHz.
SANS 61094-6:2009/ IEC 61094-6:2004	<i>Measurement microphones – Part 6: Electrostatic actuators for determination of frequency response.</i> Gives guidelines for the design of actuators for microphones equipped with electrically conductive diaphragms. Gives methods for the validation of electrostatic actuators and gives a method for determining the electrostatic actuator response of a microphone.
SANS 61326-2-1:2009/ IEC 61326-2-1:2005	<i>Electrical equipment for measurement, control and laboratory use – EMC requirements – Part 2-1: Particular requirements – Test configurations, operational conditions and performance criteria for sensitive test and measurement equipment for EMC unprotected applications.</i> Specifies detailed test configurations, operational conditions and performance criteria for equipment with test and measurement circuits (both internal and/or external to the equipment) that are not EMC protected for operational and/or functional reasons, as specified by the manufacturer.
SANS 61326-2-2:2009/ IEC 61326-2-2:2005	<i>Electrical equipment for measurement, control and laboratory use – EMC requirements – Part 2-2: Particular requirements – Test configurations, operational conditions and performance criteria for portable test, measuring and monitoring equipment used in low-voltage distribution systems.</i> Specifies detailed test configurations, operational conditions and performance criteria for equipment which is used for testing, measuring or monitoring of protective measures in low-voltage distribution systems, is powered by battery and/or from the circuit measured, and is portable.
SANS 61326-2-3:2009/ IEC 61326-2-3:2006	<i>Electrical equipment for measurement, control and laboratory use – EMC requirements – Part 2-3: Particular requirements – Test configuration, operational conditions and performance criteria for transducers with integrated or remote signal conditioning.</i> Specifies detailed test configurations, operational conditions and performance criteria for transducers with integrated or remote signal conditioning. Applies only to transducers characterized by their ability to transform, with the aid of an auxiliary energy source, a non-electric quantity to a process-relevant electrical signal, and to output the signal at one or more ports.

Standard No. and year	Title, scope and purport
SANS 61326-2-4:2009/ IEC 61326-2-4:2006	<i>Electrical equipment for measurement, control and laboratory use – EMC requirements – Part 2-4: Particular requirements – Test configurations, operational conditions and performance criteria for insulation monitoring devices according to IEC 61557-8 and for equipment for insulation fault location according to IEC 61557-9.</i> Specifies requirements for immunity and emissions regarding electromagnetic compatibility (EMC) for electrical equipment, operating from a supply or battery of less than 1 000 V a.c. or 1 500 V d.c. or from the circuit being measured, intended for professional, industrial-process, industrial-manufacturing and educational use. Specifies more detailed test configurations, operational conditions and performance criteria than SANS 61326-1.
SANS 61326-2-5:2009/ IEC 61326-2-5:2006	<i>Electrical equipment for measurement, control and laboratory use – EMC requirements – Part 2-5: Particular requirements – Test configurations, operational conditions and performance criteria for field devices with interfaces according to IEC 61784-1, CP 3/2.</i> Specifies requirements for immunity and emissions regarding electromagnetic compatibility (EMC) for electrical equipment, operating from a supply or battery of less than 1 000 V a.c. or 1 500 V d.c. or from the circuit being measured, intended for professional, industrial-process, industrial-manufacturing and educational use. In addition, it treats the particular features for EMC testing of field devices with interfaces according to IEC 61784-1, CP 3/2; covers only the field-bus interface of the equipment.
SANS 90005:2009/ ISO/IEC TR 90005:2008	<i>Systems engineering – Guidelines for the application of ISO 9001 to system life cycle processes.</i> Provides guidance for organizations in the application of SANS 9001:2008 to the acquisition, supply, development, operation and maintenance of systems and related support services.

SCHEDULE 2: AMENDMENT OF EXISTING STANDARDS

The standards mentioned have been amended in terms of section 16(3) of the Act. The number and date of a standard that has been superseded appear in brackets below the new number. In the case of an amendment issued in consolidated format, the edition number of the new (consolidated) edition appears in brackets below the number of the standard.

Standard No. and year	Title, scope and purport
SANS 63:2009 (Ed. 5.4)	Blankets. <i>Consolidated edition incorporating amendment No. 4.</i> Amended to include a requirement for wet finishing.
SANS 104:2009 (Ed. 1.1)	White metal designated WM 40. <i>Consolidated edition incorporating amendment No. 1.</i> Amended to correct the metal designation in table 1 and to delete a referenced standard that has been withdrawn.
SANS 106:2009 (Ed. 1.1)	White metal designated WM 66. <i>Consolidated edition incorporating amendment No. 1.</i> Amended to delete a referenced standard that has been withdrawn and to correct the metal designation in table 1.
SANS 107:2009 (Ed. 1.1)	White metal designated WM 72. <i>Consolidated edition incorporating amendment No. 1.</i> Amended to delete a referenced standard that has been withdrawn.
SANS 108:2009 (Ed. 1.1)	White metal designated WM 80. <i>Consolidated edition incorporating amendment No. 1.</i> Amended to delete a referenced standard that has been withdrawn.
SANS 164-6:2009 (Ed. 1.2)	Plug and socket-outlet systems for household and similar purposes for use in South Africa – Part 6: Two-pole systems, 16 A 250 V a.c., for connection of class II equipment. <i>Consolidated edition incorporating amendment No. 2.</i> Amended to change a dimensional requirement of two-pole socket-outlets for class II equipment.
SANS 205:2009/ ISO 6118:2006	Road vehicles – Elastomeric cups and seals for cylinders for hydraulic braking systems using a non-petroleum base hydraulic brake fluid (service temperature 70 °C max.). Specifies performance tests of brake cups and seals for hydraulic braking systems for road vehicles.
SANS 206:2009/ ISO 6119:2006	Road vehicles – Elastomeric seals for hydraulic disc brake cylinders using a non-petroleum base hydraulic brake fluid (Service temperature 120 °C max.). Specifies the performance test methods and requirements for elastomeric seals used in road vehicle disc cylinders.
SANS 297:2009 (Ed. 3.1)	Mastic asphalt for roofing. <i>Consolidated edition incorporating amendment No. 1.</i> Amended to change designation of SABS standards to SANS standards, to remove reference to the standardization mark, to update the definition of "acceptable", and to update the referenced standards.
SANS 493:2009 (Ed. 2.1)	Steel refuse bins. <i>Consolidated edition incorporating amendment No. 1.</i> Amended to change the designation of SABS standards to SANS standards, and to update referenced standards.
SANS 630:2009 (Ed. 3.2)	Decorative high gloss enamel paints. <i>Consolidated edition incorporating amendment No. 2.</i> Amended to correct an error on the contents page, to change the requirements for hiding power and to delete the table containing wet film thicknesses.
SANS 673:2009 (Ed. 3.2)	Mixtures of copper-chromium-arsenic compounds for timber preservation. <i>Consolidated edition incorporating amendment No. 2.</i> Amended to update referenced standards.
SANS 735:2009 (Ed. 2.2)	Cathode copper. <i>Consolidated edition incorporating amendment No. 2.</i> Amended to delete a note and referenced standard methods that have been withdrawn.
SANS 962-1:2009 (Ed. 2.2)	Mechanical fasteners for conveyor belts – Part 1: Plate-and-bolt type fasteners. <i>Consolidated edition incorporating amendment No. 2.</i> Amended to delete a referenced standard, to reduce the length of a bolt, to widen the pitch tolerance on the plate(s), and to delete reference to the certification mark.
SANS 1187:2009 (Ed. 2.2)	Tanks and ancillary equipment for milk tankers. <i>Consolidated edition incorporating amendment No. 2.</i> Amended to update the requirements for stainless steel, and to update referenced standards.

Standard No. and year	Title, scope and purport
SANS 1411-3:2009 (Ed. 2.2)	<i>Materials of insulated electric cables and flexible cords – Part 3: Elastomers. Consolidated edition incorporating amendment No. 2.</i> Amended to change the unit of measurement for the aging period of the insulation and the sheath from days to hours.
SANS 1476:2009 (Ed. 1.2)	<i>Fabricated flanged steel pipework. Consolidated edition incorporating amendment No. 2.</i> Amended to update a referenced standard.
SANS 1700-2-8:2009/ ISO 1501:2009 (SABS 1700-2-8:1996)	<i>Fasteners – Part 2: Screw threads Section 8: ISO miniature screw threads.</i> Specifies the theoretical profile associated with the basic sizes of the major, pitch and minor diameters of the thread; the deviations are applied to these basic sizes; comprises thread sizes from 0.3 mm to 1.4 mm in diameter; contains tables and the structure of the tolerance system.
SANS 1835:2009 (Ed. 1.1)	<i>Ductile iron pipes, fittings, accessories and their joints, for use in high and low pressure systems for potable and foul water. Consolidated edition incorporating amendment No. 1.</i> Amended to change the designation of SABS standards to SANS standards, to move reference to a South African government department to the foreword, to update referenced standards, to modify the requirements for the internal lining of cement mortar, and to correct a tolerance for cement lining thickness.
SANS 1920:2009 (Ed. 1.1)	<i>Mixtures of copper azole compounds for timber preservation. Consolidated edition incorporating amendment No. 1.</i> Amended to update referenced standards, and to move reference to legislation to the foreword.
SANS 3000-1:2009	<i>Railway safety management – Part 1: General.</i> Describes the minimum elements of a safety management system (SMS) to enable an operator to develop an SMS for the management of safe railway operations under its control.
SANS 4928:2009/ ISO 4928:2006	<i>Road vehicles – Elastomeric cups and seals for cylinders for hydraulic braking systems using a non-petroleum base hydraulic brake fluid (Service temperature 120 °C max.).</i> Specifies performance tests of brake cups and seals for hydraulic braking systems for road vehicles.
SANS 4930:2009/ ISO 4930:2006	<i>Road vehicles – Elastomeric seals for hydraulic disc brake cylinders using a non-petroleum base hydraulic brake fluid (Service temperature 150 °C max.).</i> Specifies the performance test methods and requirements for elastomeric seals used in road vehicle disc brake cylinders.
SANS 5725-6:2009/ ISO 5725-6:1994	<i>Accuracy (trueness and precision) of measurement methods and results – Part 6: Use in practice of accuracy values. ISO corrigendum No. 1.</i> Corrected to replace table 14 and subclause 8.4.9.2 a).
SANS 6506-1:2009/ ISO 6506-1:2005	<i>Metallic materials – Brinell hardness test – Part 1: Test method.</i> Specifies the method for the Brinell hardness test for metallic materials and is applicable up to the limit of 650 HBW.
SANS 6506-2:2009/ ISO 6506-2:2005	<i>Metallic materials – Brinell hardness test – Part 2: Verification and calibration of testing machines.</i> Specifies a method of verification and calibration of testing machines used for determining Brinell hardness in accordance with SANS 6506-1. It is also applicable to portable hardness testing machines.
SANS 6506-3:2009/ ISO 6506-3:2005	<i>Metallic materials – Brinell hardness test – Part 3: Calibration of reference blocks.</i> Specifies a method for the calibration of reference blocks to be used in the indirect verification of Brinell hardness testing machines as described in SANS 6506-2.
SANS 6508-2:2009/ ISO 6508-2:2005	<i>Metallic materials – Rockwell hardness test – Part 2: Verification and calibration of testing machines (scales A,B,C,D,E,F,G,H,K,N,T).</i> Specifies a method of verification of testing machines for determining Rockwell hardness in accordance with SANS 6508-1. It is also applicable to portable hardness testing machines.
SANS 6508-3:2009/ ISO 6508-3:2005	<i>Metallic materials – Rockwell hardness test – Part 3: Calibration of reference blocks (scales A,B,C,D,E,F,G,H,K,N,T).</i> Specifies a method for the calibration of reference blocks to be used for the indirect verification of Rockwell hardness testing machines.
SANS 10275:2009/ ISO 10275:2007	<i>Metallic materials – Sheet and strip – Determination of tensile strain hardening exponent.</i> Specifies a method for determining the tensile strain hardening exponent "n" of flat products (sheet and strip) made of metallic materials. The method is valid only for that part of the stress-strain curve in the plastic range where the curve is continuous and monotonic.
SANS 10339:2009 (Ed. 2.1)	<i>Underground rail trackwork in mines. Consolidated edition incorporating amendment No. 1.</i> Amended to update a referenced standard.
SANS 10353:2009 (Ed. 1.1)	<i>Small arms shooting ranges. Consolidated edition incorporating amendment No. 1.</i> Amended to reduce the safety angle relative to the interception of any reasonable shot, to adjust figure 1, to provide detail for the required air changes and air velocities, and to correct table E.2.
SANS 10993-4:2004/ ISO 10993-4:2002	<i>Biological evaluation of medical devices – Part 4: Selection of tests for interactions with blood. ISO amendment No. 1.</i> Amended to add more information in the scope regarding the selection and design of test methods, to modify and add more definitions, to replace tables 1 and 2, to update subclause 6.1.7, and to add a new subclause B.2.1.
SANS 11137-2:2007/ ISO 11137-2:2006	<i>Sterilization of health care products – Radiation – Part 2: Establishing the sterilization dose. ISO corrigendum No. 1.</i> Changed to correct a requirement on the interpretation of results (stage 3).
SANS 11660-1:2009/ ISO 11660-1:2008	<i>Cranes – Access, guards and restraints – Part 1: General.</i> Establishes the general requirements for access to control stations and other areas of cranes as defined in ISO 4306-1, during normal operations, maintenance, inspection, erection, dismantling and emergency. It also deals with guards and restraints in general, concerning the protection of persons on or near the crane with regard to moving parts, falling objects or live parts.
SANS 11660-3:2009/ ISO 11660-3:2008	<i>Cranes – Access, guards and restraints – Part 3: Tower cranes.</i> Establishes the particular requirements relating to access, guards and restraints for tower cranes as defined in ISO 4306-3 (published in South Africa as an identical adoption under the designation SANS 4306-3).

Standard No. and year	Title, scope and purport
SANS 16949:2009/ ISO/TS 16949:2009 (SABS ISO/TS 16949:2002)	<i>Quality management systems – Particular requirements for the application of ISO 9001:2008 for automotive production and relevant service part organizations.</i> Defines, in conjunction with ISO 9001:2008 (published in South Africa as an identical adoption under the designation SANS 9001), the quality management system requirements for the design and development, production and, when relevant, installation and service of automotive-related products. It is applicable to sites of the organization where customer-specified parts, for production or service (or both), are manufactured. Supporting functions, whether on-site or remote (such as design centres, corporate headquarters and distribution centres), form part of the site audit as they support the site, but cannot obtain stand-alone certification to this document. It can be applied throughout the automotive supply chain.
SANS 20016:2009/ ECE R16:2009 (SABS ECE R 16:2009)	<i>Uniform provisions concerning the approval of I. Safety-belts, restraint systems, child restraint systems and isofix child restraint systems for occupants of power-driven vehicles II. Vehicles equipped with safety-belts, safety-belt reminder, restraint systems, child restraint systems and isofix child restraint systems.</i>
SANS 20036:2009/ ECE R36:2008	<i>Uniform provisions concerning the approval of I. Safety-belts, restraint systems, child restraint systems and isofix child restraint systems for occupants of power-driven vehicles II. Vehicles equipped with safety-belts, safety-belt reminder, restraint systems, child restraint systems and isofix child restraint systems.</i> Applies to vehicles of category M, N, O, L2, L4, L5, L6, L7 and T, with regard to the installation of safety-belts and restraint systems that are intended for use by persons of adult build occupying forward or rearward-facing seats, safety-belts and restraint systems and are designed for installation in vehicles of category M, N, O, L2, L4, L5, L6, L7 and T, vehicles of category M1 and N1 with regard to the installation of child restraint systems and isofix child restraint systems, and vehicles of category M1 with regard to safety belt reminder.
SANS 20052:2009/ ECE R52:2008	<i>Uniform provisions concerning the approval of M2 and M3 small capacity vehicles with regard to their general construction.</i> Applies to single-deck rigid vehicles of categories M2 and M3 designed and constructed for the carriage of seated or standing persons and having a capacity not exceeding 22 passengers in addition to the driver.
SANS 20107:2009/ ECE R107:2009	<i>Uniform provisions concerning the approval of category M2 or M3 vehicles with regard to their general construction.</i> Applies to single-deck, double-deck, rigid or articulated vehicles of category M2 or M3. Does not apply to vehicles designed for the secure transport of persons, for example prisoners, vehicles specially designed for the carriage of injured or sick persons (ambulances), off-road vehicles, and vehicles specially designed for the carriage of schoolchildren.
SANS 51616:1997/ EN 1616:1997	<i>Sterile urethral catheters for single use. EN amendment No. 1.</i> Amended to include potassium dihydrogen orthophosphate in the list of components of simulated urine (A.2.1). <i>National amendment No. 1.</i> Amended to change the designation from SABS to SANS, with no technical changes.
SANS 60079-18:2009/ IEC 60079-18:2009 (SABS IEC 60079-18:2005)	<i>Explosive atmospheres – Part 18: Equipment protection by encapsulation "m".</i> Gives the specific requirements for the construction, testing and marking of electrical apparatus, parts of electrical equipment and Ex components with the type of protection encapsulation "m" intended for use in explosive gas atmospheres or explosive dust atmospheres. Applies only to encapsulated electrical equipment, encapsulated parts of electrical equipment and encapsulated Ex components (referred to as "m" equipment) where the rated voltage does not exceed 11 kV.
SANS 60079-31:2009/ IEC 60079-31:2008	<i>Explosive atmospheres – Part 31: Equipment dust ignition protection by enclosure "t". ISO corrigendum No. 1.</i> Corrected to change the foreword and to replace text on threaded entries.
SANS 60204-1:2009/ IEC 60204-1:2009 (Ed. 3.1)	<i>Safety of machinery – Electrical equipment of machines – Part 1: General requirements. Consolidated edition incorporating amendment No. 1.</i> Amended to update referenced standards, to change a reference to a clause and a figure, to change the reference to the standard for fault loop impedance in Annex A.
SANS 60335-2-16:2009/ IEC 60335-2-16:2008 (Ed. 3.1)	<i>Household and similar electrical appliances – Safety – Part 2-16: Particular requirements for food waste disposers. Consolidated edition incorporating amendment No. 1.</i> Amended to include the effect of electromagnetic phenomena on appliances, to define the scope with regard to challenged persons and children, to extend the bibliography, and to add a referenced standard.
SANS 60335-2-31:2009/ IEC 60335-2-31:2009 (Ed. 3.2)	<i>Household and similar electrical appliances – Safety – Part 2-31: Particular requirements for range hoods and other cooking fume extractors. Consolidated edition incorporating amendment No. 2.</i> Amended to change the title to include extractors intended for installing besides, behind or under cooking appliances and to add a cautionary statement regarding the safety of challenged persons and children, to add a definition and conditions for test of down-draft system, to change requirements for heating, moisture resistance, and to add a referenced standard to the bibliography.
SANS 60335-2-44:2009/ IEC 60335-2-44:2003 (Ed. 3.1)	<i>Household and similar electrical appliances – Safety – Part 2-44: Particular requirements for ironers. Consolidated edition incorporating amendment No. 1.</i> Amended to add to the foreword and the introduction, to add a cautionary statement regarding challenged persons and children, to do an editorial correction, and to add a referenced standard to the bibliography.
SANS 60335-2-47:2009/ IEC 60335-2-47:2008 (Ed. 4.1)	<i>Household and similar electrical appliances – Safety – Part 2-47: Particular requirements for commercial electric boiling pans. Consolidated edition incorporating amendment No. 1.</i> Amended to add a subclause on the classification of appliances and to revise the text on single and three-phase appliances and thermal cut-out protecting circuits.
SANS 60335-2-66:2009/ IEC 60335-2-66:2009 (Ed. 2.1)	<i>Household and similar electrical appliances – Safety – Part 2-66: Particular requirements for water-bed heaters. Consolidated edition incorporating amendment No. 1.</i> Amended to add to the foreword and the introduction, to add a cautionary statement regarding challenged persons and children, and to add a referenced standard to the bibliography.
SANS 60335-2-75:2009/ IEC 60335-2-75:2009 (Ed. 2.2)	<i>Household and similar electrical appliances – Safety – Part 2-75: Particular requirements for commercial dispensing appliances and vending machines. Consolidated edition incorporating amendment No. 2.</i> Amended to add to the foreword and the introduction, to do editorial corrections, to include a requirement for moisture resistance, and to add a referenced standard to the bibliography.
SANS 60745-2-1:2009/ IEC 60745-2-1:2008 (Ed. 2.1)	<i>Hand-held motor-operated electric tools – Safety – Part 2-1: Particular requirements for drills and impact drills. Consolidated edition incorporating amendment No. 1.</i> Amended to change the scope, to make editorial changes to the copy, to add new drill safety warnings, to replace the existing text on the endurance requirements for impact drills, their components and construction, and to amend the text of annexes K and L.

SCHEDULE 3: CANCELLATION OF STANDARDS

In terms of section 16(3) of the Act the following standards have been cancelled.

Standard No. and year	Title
SANS 1392:2002	<i>Soft-top suitcases.</i>
SANS 14509:2008	<i>Small craft – Measurement of airborne sound emitted by powered</i>

SCHEDULE 4: ADDRESSES OF SABS OFFICES

The addresses of offices of the South African Bureau of Standards where copies of standards mentioned in this notice can be obtained, are as follows:

1. The CEO, South African Bureau of Standards, 1 Dr Lategan Road, Groenkloof, Private Bag X191, Pretoria 0001.
2. The Manager, Western Cape Regional Office, SABS, Liesbeek Park Way, Rosebank, PO Box 615, Rondebosch 7701.
- 3 The Manager, Eastern Cape Regional Office, SABS, 30 Kipling Road, cor. Diaz and Kipling Roads, Port Elizabeth, PO Box 3013, North End 6056.
4. The Manager, KwaZulu-Natal Regional Office, SABS, 15 Garth Road, Waterval Park, Durban, PO Box 30087, Mayville 4058.
5. The Control Officer, Bloemfontein Branch Office, SABS, 34 Victoria Road, Willows, Bloemfontein, PO Box 20265, Willows 9320.

GENERAL NOTICES ALGEMENE KENNISGEWINGS

NOTICE 1667 OF 2009

AIR TRAFFIC AND NAVIGATION SERVICES COMPANY LIMITED

AIR TRAFFIC AND NAVIGATION SERVICES COMPANY ACT, 1993 (ACT No. 45 OF 1993) PUBLICATION OF AIR TRAFFIC SERVICE CHARGES

In terms of section 5(2)(f) of the Air Traffic and Navigation Services Company Act, 1993 (Act No. 45 of 1993), it is hereby published for general notice that as from **1 April 2010** the Air Traffic and Navigation Services Company Limited, registration number 1993/004150/06, will levy the air traffic service charges according to the rules set out in the Schedule.

MD MAMASHELA

Chairman : Board of Directors

December 2009

SCHEDULE

AIR TRAFFIC SERVICE CHARGES

1. Interpretation

For the purposes of these Rules, unless the context indicates otherwise -

- (a) “ACSA” means Airports Company South Africa Limited;
- (b) “ACSA airport” means a company airport as defined in section 1 of the Airports Company Act;
- (c) “ACSA TMA airspace” means TMA airspace associated with an ACSA airport, but in which may also be non-ACSA airports;
- (d) “area (*en route*) airspace” means airspace that excludes -
 - (i) aerodrome airspace;
 - (ii) TMA airspace; and
 - (iii) FIS-only airspace, when the Company has determined its dimensions;
- (e) “aircraft” means any machine that can derive support in the atmosphere from the reactions of the air other than the reactions of the air against the earth’s surface, and includes any non-type certificated aircraft;
- (f) “airport” means an aerodrome as defined in section 1 of the Aviation Act, 1962 (Act No. 74 of 1962), and includes an ACSA airport;
- (g) “Airports Company Act” means the Airports Company Act, 1993 (Act No. 44 of 1993), as amended;
- (h) “air traffic service charge” means an amount levied by the Company on the operator of an aircraft in connection with the provision of air traffic services to that operator;
- (i) “air traffic service unit” means an air traffic control unit, flight information centre or air traffic service reporting office;
- (j) “ATM” means air traffic management;
- (k) “air traffic management (ATM) services” includes without limitation -
 - (i) airspace organisation and management services;
 - (ii) information management services;
 - (iii) alerting services;
 - (iv) advisory services;
 - (v) conflict management services;
 - (vi) traffic synchronisation services;
 - (vii) flight information services; and
 - (viii) demand and capacity balancing services;

- (l) "BSC" means business sustaining cost;
- (m) "Civil Aviation Regulations" means the Civil Aviation Regulations, 1997, as amended;
- (n) "Company" means Air Traffic and Navigation Services Company Limited;
- (o) "Company representative" means a person designated by the Company for the purposes of these Rules;
- (p) "d" means flight distance;
- (q) "FAJS" means OR Tambo International Airport;
- (r) "FAKN" means Kruger Mpumalanga International Airport;
- (s) "FARB" means Richards Bay Airport;
- (t) "FC" means fixed cost;
- (u) "FIS-only airspace" means airspace in which flight information services are provided exclusively;
- (v) "flight" means from the moment an aircraft commences its take-off until the moment it completes its next landing;
- (w) "gateway" means the point of entry into or exit from the South African flight information region;
- (x) "maximum certificated mass" means the maximum permissible mass shown in the aircraft flight manual or other document associated with the certificate of airworthiness at which an aircraft may commence its take-off under standard atmospheric conditions at sea level;
- (y) "MCM" means maximum certificated mass;
- (z) "movement" means a flight, or a portion of a flight, through any aerodrome airspace, TMA airspace or area (*en route*) airspace;
- (aa) "non-type certificated aircraft" includes without limitation any amateur-built, production-built, ex-military and vintage aircraft;
- (bb) "operator", in relation to an aircraft, means -
 - (i) a licensee as defined in section 1 of the Air Services Licensing Act, 1990 (Act No. 115 of 1990), as amended, or a licensee as defined in section 1 of the International Air Services Act, 1993 (Act No. 60 of 1993), as amended;
 - (ii) any airline of another State which operates a scheduled international public air transport service in terms of an air transport service agreement as contemplated in section 35(1) of the International Air Services Act, 1993, as amended, or a permit holder as defined in section 1 of the said Act;
 - (iii) the owner of such aircraft; and
 - (iv) any person who uses an aircraft on behalf of an operator;

- (cc) "owner", in relation to an aircraft, means the person in whose name such aircraft is registered, and includes any person who is or has been acting as agent in South Africa for a foreign owner;
- (dd) "Regulating Committee" means the Regulating Committee established by section 11 of the Airports Company Act;
- (ee) "South African flight information region" means the geographical area consisting of the flight information regions of Johannesburg, Cape Town and Johannesburg Oceanic;
- (ff) "South African Maritime and Aeronautical Search and Rescue Act" means the South African Maritime and Aeronautical Search and Rescue Act, 2002 (Act No. 44 of 2002);
- (gg) "Standard Terms and Conditions" are the terms and conditions of payment set out on the invoice;
- (hh) "state aircraft" means any state aircraft as contemplated in article 3 of the Convention on International Civil Aviation signed at Chicago on 7 December 1944;
- (ii) "terminal control area" means a control area normally established at the confluence of air traffic service routes in the vicinity of one or more ACSA airports;
- (jj) "TMA" means terminal control area; and
- (kk) "VC" means variable cost.

2. Right to levy air traffic service charges

The Company is entitled to levy air traffic service charges by virtue of a permission issued by the Regulating Committee on 22 June 2007 in terms of section 11(5) of the Air Traffic and Navigation Services Company Act, 1993, and published by Notice 785 of 22 June 2007.

3. Air traffic service charges

3.1 There are three air traffic service charges:

- (a) An Aerodrome Charge, payable for ATM services, specific to aerodrome airspace and maneuvering area, provided by the Company in respect of a flight that takes off from or lands at an ACSA airport;
- (b) a TMA Access Charge, payable for ATM services, specific to terminal airspace, provided by the Company in respect of a flight that departs from or arrives at ACSA TMA airspace, where the airport of origin or destination is within that ACSA TMA airspace;
- (c) an Area Charge, payable for ATM services specific to area (*en route*) airspace provided by the Company in respect of a flight undertaken within a flight information region

established by the Commissioner for Civil Aviation in terms of the Civil Aviation Regulations.

4. Cost components

4.1 Charges consist of the following cost components:

- (a) A variable cost component (VC);
- (b) a business sustaining cost component (BSC); and
- (c) a fixed cost component (FC).

4.2 VCs are treated as follows:

- (a) VCs are charged for each flight undertaken at a standard rate per movement;
- (b) VCs are the same for Aerodrome Charges, TMA Access Charges and Area Charges.

4.3 BSCs are treated as follows:

- (a) BSCs are charged for each movement undertaken in relation to the MCM of an aircraft;
- (b) BSCs are the same for Aerodrome Charges, TMA Access Charges and Area Charges.

4.4 FCs are treated as follows:

- (a) FCs are charged for each movement undertaken in relation to the MCM of an aircraft, and for Area Charges, also in relation to d within Company managed airspace;
- (b) Aerodrome Charges, TMA Access Charges and Area Charges each have a unique FC.

5. Independent variables

For purposes of charging, the independent variables of the tariff formulas set out in the Appendix, are the following:

- (a) Published MCM expressed in kilograms;
- (b) d measured on the basis of the great circle distance in nautical miles (rounded to the nearest nautical mile) along that portion of the flight path of an aircraft, which is within the boundaries of the South African flight information region, from the take-off airport or gateway to the landing airport or gateway. It excludes distance flown in the ACSA

TMA airspace above the take-off or landing airport or the TMA airspace above FAKN or FARB, which TMA airspace is for charging purposes a radius of 35 nautical miles around the airport, irrespective of the actual radius.

6. Mass categories

6.1 Subject to the exceptions described in rules 6.2 and 6.3 below, the following aircraft mass categories apply:

- (a) Aircraft with a MCM of 15 000 kilograms or less are charged as follows:
 - (i) VC per movement;
 - (ii) BSC based on MCM; and
 - (iii) FC based on MCM, and for Area Charge, also based on d, but no Area Charge is levied if d equals zero;
- (b) aircraft with a MCM of more than 15 000 kilograms are charged as follows:
 - (i) VC per movement;
 - (ii) BSC based on the square root of MCM; and
 - (iii) FC based on the square root of MCM, and for Area Charge, also based on d, but no Area Charge is levied if d equals zero.

6.2 Charges for aircraft with a MCM of 5 000 kilograms or less are zero-rated with respect to -

- (a) Area Charges; and
- (b) Aerodrome Charges or TMA Access Charges at ACSA airports or ACSA TMA airspace other than FAJS subject to the operators of such aircraft adhering to operating procedures around non-FAJS airports as the Company may establish from time to time.

6.3 For aircraft with a MCM of 5 000 kilograms or less at FAJS, the FC components that would otherwise have applied, are replaced with -

- (a) a minimum FC in the calculation of the Aerodrome Charge; and
- (b) a minimum FC in the calculation of the TMA Access Charge.

7. Origin-destination differentiation

7.1 Differentiation applies in respect of the following flights:

- (a) A domestic flight, which is a flight undertaken by an aircraft where both the airport of departure and the airport of arrival of the aircraft are within South Africa;
- (b) a regional flight, which is a flight undertaken by an aircraft where either the airport of departure or the airport of arrival of the aircraft is within Botswana, Lesotho, Namibia or Swaziland, and the other airport is within South Africa or within Botswana, Lesotho, Namibia or Swaziland;
- (c) an international flight, which is a flight undertaken by an aircraft where either the airport of departure or the airport of arrival of the aircraft is within any State other than South Africa or Botswana, Lesotho, Namibia or Swaziland, and the other airport is within South Africa or elsewhere.

7.2 All tariff cost components, except the minimum FC in respect of an aircraft with a MCM of 5 000 kilograms or less for Aerodrome and TMA Access at FAJS (where a minimum, non-differentiated FC applies), are differentiated based on origin-destination as set out in the Appendix.

8. Formulas and coefficients

Subject to these Rules, the tariff formulas and tariff coefficients are set out in the Appendix.

9. Payment of air traffic service charges and security deposits

9.1 Any document produced by the Company on which it is recorded that an ATM service was provided is deemed to be sufficient evidence that the ATM service was indeed provided.

9.2 The operator of an aircraft which is engaged in a flight in respect of which the operator is liable to pay an air traffic service charge in terms of these Rules and in the case where the flight –

- (a) terminates at an ACSA airport, must pay the air traffic service charge to the Company representative at that ACSA airport before that aircraft is to take off from that ACSA airport;
- (b) commences at an ACSA airport and terminates at an airport other than an ACSA airport, must pay the air traffic service charge to the Company representative at that ACSA airport before that aircraft is to take off from that ACSA airport;

- (c) commences and terminates at airports other than ACSA airports, must pay the air traffic service charge to the Company within 30 days of receipt of an invoice from the Company in respect of the air traffic service charge,

unless the operator has previously entered into an agreement with the Company for payment.

9.3 The Company may require the operator of an aircraft to –

- (a) deposit with the Company an amount, or
- (b) to provide the Company with a letter of guarantee by a financial institution in a format acceptable to the Company that an amount has been set aside as security against the risk of default on payment.

9.4 The Company shall determine the amount referred to in section 9.3 with reference to the actual or expected invoices of an operator, which amount shall be limited to the maximum amount of two months' invoicing.

9.5 The Company may annually revise and an operator may annually apply for a revision of the amount in section 9.3, with reference to actual or expected invoicing.

9.6 No interest is payable by the Company on any deposit or letter of guarantee held by it in terms of these Rules.

9.7 The Company may charge interest on an outstanding invoice as provided for in the Standard Terms and Conditions.

9.8 The Company is not obliged to withdraw, modify or reissue an invoice after six months from the date of the invoice.

10. General rules, exemptions and exceptions

10.1 The tariffs set out in these Rules, including the Appendix, are exclusive of Value-Added Tax and are therefore subject to the appropriate rate applicable to any specific tariff.

10.2 Air traffic service charges are payable by the operator of an aircraft to the Company.

- 10.3 Air traffic service charges are payable in respect of South African and foreign state aircraft, unless other provision has been made by means of an agreement with the Company.
- 10.4 Air traffic service charges are payable in respect of helicopters, except at FAJS where no TMA Access Charge is levied.
- 10.5 No air traffic service charge is payable in respect of an aircraft engaged in any flight for the calibration of any air navigation infrastructure.
- 10.6 Air traffic service charges are payable in respect of an aircraft engaged in emergency medical service operations, unless exempted on a case-by-case basis by means of an agreement with the Company.
- 10.7 Subject to rule 10.9 below, no air traffic service charge is payable in respect of an aircraft requisitioned for and engaged in search and rescue operations in terms of the South African Maritime and Aeronautical Search and Rescue Act.
- 10.8 Air traffic service charges are payable in respect of an aircraft engaged in search and rescue operations, which aircraft has not been requisitioned in terms of the South African Maritime and Aeronautical Search and Rescue Act, unless exempted on a case-by-case basis by means of an agreement with the Company.
- 10.9 Search mission co-ordination services are payable by the relevant authority or any operator at a rate of R950,00 per hour or part thereof, where these services fall outside of the normal scope of alerting services and assistance to agencies involved in search and rescue operations, in particular where services are activated due to negligence in canceling service requests.
- 10.10 (a) Aerodrome Charges and TMA Access Charges are payable in respect of Aerodrome and TMA Access movements solely for the purpose of air crew training at a discount of 70% of the applicable standard Aerodrome Charge or standard TMA Access Charge.
- (b) Training movements attract charges as follows:
- (i) An Aerodrome Charge is levied for each training movement upon take-off and upon landing from or at an ACSA airport, discounted as described in rule 10.10(a) above;

- (ii) for a training movement that does not exit the aerodrome airspace, one Aerodrome Charge is levied for each circuit flown, discounted as described in rule 10.10(a) above; and
 - (iii) for a training movement that exits the aerodrome airspace into TMA airspace, rule 10.10(b)(i) above applies for each take-off and each landing, and a TMA Access Charge is levied for each circuit flown within the TMA airspace.
- (c) For the purposes of this rule, the words "take-off" and "landing" are construed to include the use of ATM services required for take-off and landing.
- 10.11 For oceanic flights over the Indian Ocean or the Atlantic Ocean within the South African flight information region, including those to and from Antarctica, the FC component of the Area Charge is 50% of the standard Area Charge.
- 10.12 Extended air traffic service charges at a rate of R1 910,00 per hour or part thereof, are payable by an operator for the extension of existing air traffic services beyond the normal negotiated and planned service amendments as documented in the Integrated Aeronautical Information Package (IAIP).
- 10.13 No Area Charge is payable in respect of any aircraft engaged in a flight that takes off and lands at the same airport.
- 10.14 Subject to a directive or approval to the contrary by the Regulating Committee, the origin-destination differentiation described in rule 7 above, will be phased out as follows:

Financial year	Domestic flight tariff	Regional flight tariff	International flight tariff
2010/11	88%	100%	112%
2011/12	91%	100%	109%
2012/13	94%	100%	106%
2013/14	97%	100%	103%
2014/15	100%	100%	100%

- 10.15 The Company reserves the right to exempt the operator of an aircraft from payment of, or discount, any of the air traffic service charges if the Company is satisfied that the application of these Rules would amount to an unfair repetition of the same charge.

11. Withholding of services

The Company may withhold services –

- (a) until such time that the operator provides evidence to the Company that the deposit or guarantee referred to in section 9.3 has been provided, or
- (b) if the operator has failed to settle an invoice as per the Standard Terms and Conditions.

APPENDIX

TARIFF FORMULAS AND COEFFICIENTS

1. An air traffic service charge is composed of the sum of VC, BSC and FC for each discrete Aerodrome, TMA Access and Area movement undertaken, according to the following mass categories and locations:

Main Mass Category	Cost Component	Formulas & Coefficients		
		Aerodrome Charge	TMA Access Charge	Area Charge
FAJS ≤ 5 000 kg	VC	R18.00	R18,00	
	BSC	$R73.14/10\ 000.MCM$	$R73.14/10\ 000.MCM$	
	FC	R38.59	R71.29	
5 000 kg < MCM ≤ 15 000 kg	VC	R18.00	R18,00	R18,00
	BSC	$R73.14/10\ 000.MCM$	$R73.14/10\ 000.MCM$	$R73.14/10\ 000.MCM$
	FC	$R77.19/10\ 000.MCM$	$R14.26/1\ 000.MCM$	$R10.23/100\ 000.MCM.d$
> 15 000 kg	VC	R18.00	R18.00	R18.00
	BSC	$R89.56/100.\sqrt{MCM}$	$R89.56/100.\sqrt{MCM}$	$R89.56/100.\sqrt{MCM}$
	FC	$R94.54/100.\sqrt{MCM}$	$R174.63/100.\sqrt{MCM}$	$R125.36/10\ 000.\sqrt{MCM.d}$

2. Each Rand-value coefficient in the table above is multiplied by –

- (a) 88% for a domestic flight;
- (b) 100% for a regional flight; and
- (c) 112% for an international flight,

except in the case of FCs for Aerodrome and TMA Access Charges at FAJS for aircraft with $MCM \leq 5\ 000\ kg$ where the coefficient as stated in the table applies.

3. As an illustration, assume the following flights:

Example 1

Domestic flight from FAJS to FACT, with aircraft with $MCM = 100\ 000\ kg$ and $d = 686\ miles$

$$\begin{aligned}
 \text{Charge} &= [\text{Aerodrome Charge at FAJS} + \text{TMA Access Charge at FAJS} + \text{Area Charge} + \text{TMA} \\
 &\quad \text{Access Charge at FACT} + \text{Aerodrome Charge at FACT}] \times 88\% \\
 &= [(VC_{Aero} + BSC_{Aero} + FC_{Aero}) + (VC_{TMA} + BSC_{TMA} + FC_{TMA}) + (VC_{Area} + BSC_{Area} + FC_{Area}) \\
 &\quad + (VC_{TMA} + BSC_{TMA} + FC_{TMA}) + (VC_{Aero} + BSC_{Aero} + FC_{Aero})] \times 88\% \\
 &= [(R18,00 + (R89,56/100 \times \sqrt{100\ 000}) + (R94,54/100 \times \sqrt{100\ 000})) + [R18,00 + (R89,56/100 \\
 &\quad \times \sqrt{100\ 000}) + (R174,63/100 \times \sqrt{100\ 000})] + [R18,00 + (R89,56/100 \times \sqrt{100\ 000}) + \\
 &\quad (R125,36/10\ 000 \times \sqrt{100\ 000 \times (686-35-35)})] + [R18,00 + (R89,56/100 \times \sqrt{100\ 000}) +
 \end{aligned}$$

$$\begin{aligned}
 & (R174,63/100 \times \sqrt{100\,000})] + [R18,00 + (R89,56/100 \times \sqrt{100\,000}) + (R94,54/100 \times \\
 & \sqrt{100\,000})] \times 88\% \\
 = & [(R18,00 \times 5) + (R89,56/100 \times \sqrt{100\,000} \times 5) + (R94,54/100 \times \sqrt{100\,000} \times 2) + \\
 & (R174,63/100 \times \sqrt{100\,000} \times 2) + (R125,36/10\,000 \times \sqrt{100\,000} \times 616)] \times 88\% \\
 = & R\,4\,972,37
 \end{aligned}$$

Example 2

International flight from FAJS to international gateway, with aircraft with MCM = 4 500 kg
and d = 211 miles

$$\begin{aligned}
 \text{Charge} &= [\text{Aerodrome Charge at FAJS} + \text{TMA Access Charge at FAJS}] \times 112\% \\
 &= [(VC_{\text{Aero}} + BSC_{\text{Aero}}) \times 112\% + FC_{\text{Aero}}] + [(VC_{\text{TMA}} + BSC_{\text{TMA}}) \times 112\% + FC_{\text{TMA}}] \\
 &= [(R18,00 + (R73,14/10\,000 \times 4\,500)) \times 112\% + R38,59] + [(R18,00 + (R73,14/10\,000 \times \\
 & 4\,500)) \times 112\% + R71,29] \\
 &= [(R18,00 \times 2) + (R73,14/10\,000 \times 4\,500 \times 2)] \times 112\% + R38,59 + R71,29 \\
 &= R223,93
 \end{aligned}$$

NOTICE 1668 OF 2009

Notice and Order of Forfeiture

Notice of Forfeiture to the State of money and/or goods in terms of the provisions of Regulation 22B of the Exchange Control Regulations made under Section 9 of the Currency and Exchanges Act, 1933 (Act No. 9 of 1933), as amended, as promulgated by Government Notice No. R.1111 of 1961-12-01 in respect of the money of:

DEB 123 Electronic Systems Close Corporation (the "Respondent")

of:

23 Smith Street
Forrest Hill
Johannesburg
2001

Be pleased to take notice that:

1. The Minister of Finance has, by virtue of the provisions of Regulation 22E of the Exchange Control Regulations delegated all the functions and/or powers conferred upon the Treasury by the provisions of the Exchange Control Regulations [with the exception of the functions and/or powers conferred upon the Treasury by Regulations 3(5) and (8), 20 and 22 of the Exchange Control Regulations but which exception does not include the functions and/or powers under Regulations 22A, 22B, 22C and 22D] of the Exchange Control Regulations, and assigned the duties imposed thereunder on the Treasury, to, *inter alia*, a Deputy Governor of the South African Reserve Bank.
2. By virtue of the functions, powers and/or duties vested in me as a Deputy Governor of the South African Reserve Bank, in terms of the delegation and assignment of the functions, powers and/or duties referred to in 1 above, I hereby give notice of a decision to forfeit to the State the following money and I hereby declare and order forfeited to the State the following money, namely:
 - 2.1 A capital amount of Rand 3 032 038-00 which stood to the credit of the Respondent in account number 4000421158, held in its name with Mercantile Bank Limited, together with any interest thereon and/or any other accrual thereto.
3. The date upon which the money specified in 2 above is hereby forfeited to the State is the date upon which this Notice of Forfeiture is published in this Gazette.
4. The money specified in 2 above shall be disposed of by deposit of the proceeds thereof to the National Revenue Fund.
5. This Notice also constitutes a written order, as contemplated in Regulation 22B of the Exchange Control Regulations, in terms of which the money specified in 2 above is hereby forfeited to the State.
6. Signed at Pretoria on this _____ day of _____ 2009.



A D Mminele
Deputy Governor
South African Reserve Bank